



Portable Blender Instruction Manual

MODEL: BL-3326



Ginnys.com • 1.800.544.1590

*"Life is happening.
We'll help you live it...one moment at a time."*



Thank you for purchasing a Ginny's Brand Blender and To-Go Cup! It's not only sized just for you with its one- to two- serving capacity, but once you've blended your smoothie or shake, it'll even double as your travel cup! Just blend, twist off and take along. It couldn't be easier. Enjoy!

Ginny
President, Ginny's

TABLE OF CONTENTS

Important Safeguards	3
Specifications	4
Part Names	5
Installation	6
How to Operate	7
Cleaning & Care	8
Troubleshooting	8
Recipes	9-10
Warranty	11

IMPORTANT SAFEGUARDS

When using electrical appliances, basic safety precautions should always be followed, including the following:

1. Read all instructions before using.
2. To protect against risk of electric shock, do not put unit, cord or plug in water or other liquids.
3. Do not let cord hang over edge of table or counter.
4. Never use attachments not made for this appliance.
5. Close supervision is necessary when this appliance is used near children. Children should be supervised to ensure that they do not play with this appliance.
6. Do not operate any appliance with a damaged cord or plug, after the appliance malfunctions, or has been damaged in any manner. For a replacement or return, please contact Ginny's Customer service at our toll-free number.
7. Avoid contact with moving parts. Keep hands, hair, clothing and other utensils away during operation to reduce the risk of personal injury and/or damage this blender.
8. Do not use outdoors. This blender is designed for household use only.
9. Only use this blender for its intended use.
10. Handle this blender carefully, the blades are very sharp.
11. Never leave this blender unattended while it is running.
12. Unplug the blender from the outlet when not in use and before cleaning.
13. Do not place this blender on or near any heat source.
14. This appliance is not intended for use by persons with reduced physical sensory or mental capabilities, or lack of experience or knowledge. He, or she should not operate this appliance unless he, or she is given supervision and instruction concerning use of the appliance by a person responsible for their safety.

SAVE THESE INSTRUCTIONS

No user-serviceable parts inside. A short cord is provided to reduce the hazards resulting of entanglement or tripping over a long cord. An extension cord may be used with care, however, the marked electrical rating should be at least as great as the electrical rating of this appliance. The extension cord should not be allowed to drape over the counter or tabletop where it can be pulled on by children or tripped over.

FOR HOUSEHOLD USE ONLY

To reduce the risk of electrical shock, this Portable Blender is equipped with a polarized plug, in which one prong is wider than the other. This plug is intended to fit into a polarized outlet only in one direction. If the plug does not fit fully into the outlet, reverse the plug. If it still does not fit, contact a qualified electrician. Do not attempt to modify the plug in any way.

SPECIFICATIONS

Product Size:	4.75" Diam. x 6.25" W x 15" H
Cord Length:	24"
Rate:	AC 120V 60Hz
Wattage:	250W
Capacity:	20 oz.

PART NAMES

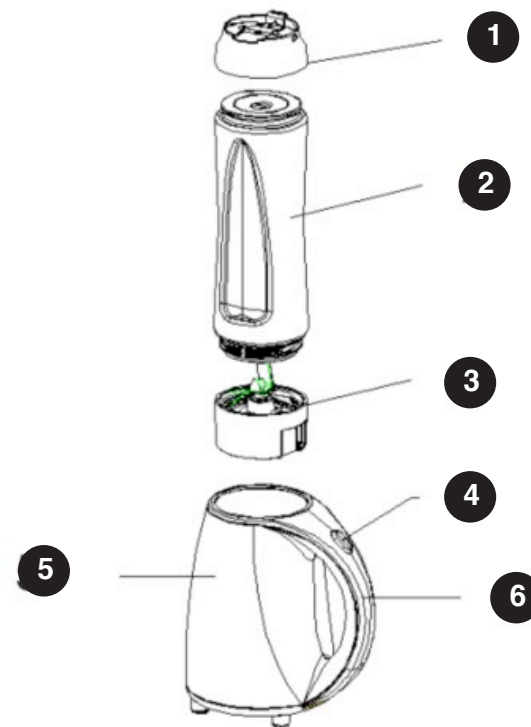

1. Jar Cover
2. Blender Jar
3. Blade Assembly
4. On/Off Switch
5. Blender Base
6. Handle

INSTALLATION

BEFORE USING FOR THE FIRST TIME:

1. Remove all packaging.
2. Wash all parts: see "CLEANING & CARE" on page 8.

BEFORE PLUGGING IN:

- **Make sure your electricity supply is the same as the electrical rating specified on the underside of the power unit.**
 - **Make sure to fully assemble your portable blender before turning it on or plugging it into a power source.**
1. Place the blender jar on a dry, level, heat-resistant surface.
 2. Attach the blade assembly to the blender jar by turning the blade assembly counter-clockwise until it is attached to the blender jar securely.
 3. Place the assembled blade and jar into the blender base by lining up the tabs on the blade assembly to the notches inside the blender base.
 4. Turn the blender jar clockwise while holding the blender base securely until it locks into position. This will make a clicking noise.

HOW TO OPERATE

1. Fill the blender jar with ingredients according to the recipe instructions. Do not add ingredients past the maximum fill line (20 oz.)
2. Attach the blade assembly to the blender jar by turning the blade assembly counter-clockwise until tightened securely on the blender jar.
3. Turn the assembled jar over and place on the blender base by lining up the tabs. Turn the blender jar clockwise until it locks and clicks into position on the blender base.
4. Plug the blender into a power supply.
5. Press the switch button to turn on the blender.
6. When blending is completed, turn OFF the blender and unplug from the power supply.
7. Remove the blender jar and blade assembly from the blender base by turning counter-clockwise.
8. Carefully detach the blade assembly from the blender jar by turning counter-clockwise.
9. Attach the jar cover to the blender jar by turning it clockwise.
10. This can be served to enjoy directly from the blender jar, or poured and served.

IMPORTANT

- **Do not use hot liquids inside the blender jar or operate this blender when empty.**
- Do not run this blender for more than 3 minutes at a time.
- A rest period of 1 minute is needed for this blender before using again.
- Do not use more than 1 cup of cubed ice at a time.

CLEANING & CARE

Always switch Off, unplug and disassemble this blender before cleaning.

- Never immerse the blender base in water, or let the cord or plug get wet.
- Allow the blender to cool down prior to cleaning.
- Do not use scouring powders, steel wool pads or other abrasive materials to clean this blender.

BLENDER BASE

- Detach the blender jar and blade assembly from the blender base prior to cleaning.
- Wipe down the blender base with a warm, damp cloth.
- Dry thoroughly.
- Do not immerse in water.

BLENDER JAR, BLADE ASSEMBLY & JAR COVER

- Remove from blender base prior to cleaning.
- Wash in warm, soapy water.
- Dry thoroughly.
- The blender jar, blade assembly and jar cover are all top rack dishwasher safe.

TROUBLESHOOTING

Before asking for service, please check for the following:

1. Check that the blender is plugged in securely. If it is not, remove the plug from the outlet, wait 10 seconds, and plug it in again securely.
2. Check for a blown circuit fuse or a tripped circuit breaker. If these seem to be operating properly, test the outlet with another appliance.

**If none of the above rectify the situation, contact
Customer Service
1.800.544.1590**

Do not try to adjust or repair the appliance yourself.

RECIPES

MANGO SMOOTHIE

INGREDIENTS:

1 cup fresh mango, skinned & pitted	½ cup milk
½ cup plain yogurt	½ cup ice cubes
1 Tbsp. honey	

DIRECTIONS:

1. In the blender, combine all ingredients. Blend until smooth.
2. Enjoy in the to-go cup, or serve in a glass.

BLUEBERRY BANANA SLUSHY

INGREDIENTS:

1 frozen banana	½ cup frozen blueberries
½ cup orange juice	½ Tbsp. honey (optional)

DIRECTIONS:

1. In the blender, combine all ingredients. Blend until smooth. Add honey, if the slushy is not sweet enough, and blend again.
2. Enjoy in the to-go cup, or serve in a glass.

ORANGE BANANA SMOOTHIE

INDREDIENTS:

1 cup orange juice	1 Tbsp. lime juice
1 cup fresh strawberries	1 ripe banana

DIRECTIONS:

1. In the blender, combine all ingredients. Blend until smooth.
2. Refrigerate until cold.
3. Enjoy in the to-go cup, or serve in a glass.

RECIPES

PEACH MILKSHAKE

INGREDIENTS:

2 scoops vanilla ice cream	2 fresh peaches, peeled and chopped
½ cup milk	¼ tsp. cinnamon
½ tsp. vanilla extract	

DIRECTIONS:

1. In the blender, combine all ingredients. Blend until smooth.
2. Enjoy in the to-go cup, or serve in a glass.

STRAWBERRY ORANGE COCKTAIL

INGREDIENTS:

1 cup fresh strawberries	2/3 cup orange juice (4 oranges)
1 cup ice cubes	3 oz. rum (optional)

DIRECTIONS:

1. In the blender, combine all ingredients. Blend until smooth.
2. Enjoy in the to-go cup, or serve in a glass.

STRAWBERRY DAIQUIRI

INGREDIENTS:

1 cup fresh strawberries	1 Tbsp. sugar
1 Tbsp. lemon juice	1 scoop vanilla ice cream
1 cup ice cubes	2 oz. rum (optional)

DIRECTIONS:

1. In the blender, combine all ingredients. Blend until smooth.
2. Enjoy in the to-go cup, or serve in a glass.

WARRANTY

Ginny's warrants this product free from defects in material and workmanship for one year from provable date of purchase.

Within this warranty period, Ginny's will repair or replace, at its option, defective parts at no charge, provided the product is returned, freight prepaid with proof of purchase to Ginny's.

Allow 2-4 weeks for return shipping.

This warranty does not cover improper installation, misuse, abuse or neglect on part of the owner. Warranty is also invalid in any case that the product is taken apart or serviced by an unauthorized service station.

This warranty gives you specific legal rights and they may vary from state to state.

THE FOREGOING WARRANTIES ARE IN LIEU
OF ALL OTHER WARRANTIES AND CONDITIONS,
EXPRESS OR IMPLIED,
INCLUDING BUT NOT LIMITED TO THOSE OF
MERCHANTABILITY OR FITNESS
FOR A PARTICULAR PURPOSE.



Customer Service

Phone: 1-800-544-1590

8:00 am to Midnight, Monday through Friday