

**OneStepAhead<sup>®</sup>**  
**EURO II HIGH CHAIR**



**Assembly Instructions.**  
**Adult Assembly Required.**  
**Read all instructions before use.**  
**Save instructions for future use.**

Never use with missing parts or hardware.

**MODEL #22168**

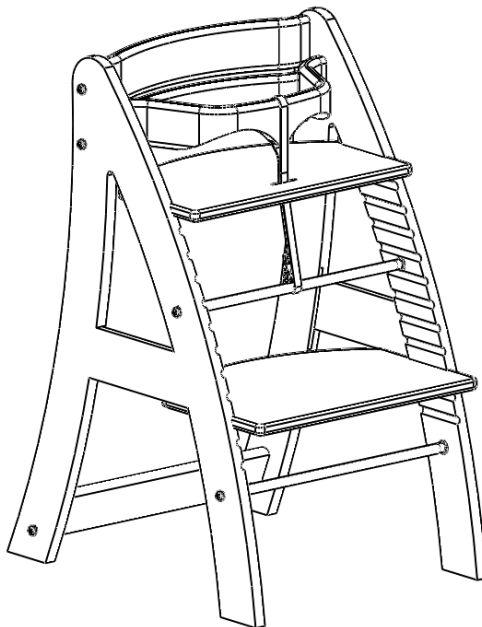

**OneStepAhead<sup>®</sup>**

75 Albrecht Drive  
Lake Bluff, IL 60044  
1-800-950-5120  
[www.onestepahead.com](http://www.onestepahead.com)

## CARE INSTRUCTIONS:

Wipe the seat cushion with a damp cloth after each use;  
Periodically wipe down the chair with a damp cloth and mild detergent.



**WARNING! FAILURE TO FOLLOW THESE WARNINGS AND THE INSTRUCTIONS MAY RESULT IN SERIOUS INJURY OR DEATH. WARNING: TO PREVENT SERIOUS INJURY OR DEATH FROM FALLS OR SLIDING OUT ALWAYS SECURE CHILD IN THE RESTRAINT. NEVER LEAVE CHILD UNATTENDED.**

- REGULARLY check the bolts and retighten as needed using the included wrench.
- READ ALL INSTRUCTIONS before use of this product. Keep instructions for future use.
- Use only the parts and hardware provided.
- Hardware may include small parts.
- Choking Hazard! Keep unassembled parts out of the reach of small children.
- You may begin using this chair when your child is sitting unassisted.
- The child should be secured in the high chair at all times by the restraining system, regardless of your child's age/weight or the height position of the seat.
- ALWAYS keep your child in view while in the chair.
- Never leave your child unattended, not even for "just a minute"
- No product is a replacement for adult supervision.
- Once the chair is assembled and all the bolts are tightened, the seat and footrest platforms SHOULD NOT HAVE ANY MOVEMENT front to back or side-to-side.
- If your seat and/or footrest is NOT FIRMLY HELD IN POSITION, DO NOT USE THE CHAIR until you have contacted One Step Ahead for assistance.
- DO NOT skip installation of the passive restraint crotch belt if you are installing the Curved Front Rail.
- Curved Front Rail and Crotch Restraint Belt are ONLY FOR USE WITH THE SEAT PANEL IN THE TOPMOST HEIGHT POSITION.
- If you adjust the seat height to a lower position for any reason, you MUST REMOVE and not use the Curved Front Rail and Crotch Restraint Belt parts.
- DO NOT allow anyone to climb, stand on, or play on or inside of this product. It is not a step stool or ladder.
- ALWAYS ensure the chair is on a flat and level surface.
- BE AWARE of what items are in the area around the chair which your child can reach, grab, or pull that could be a choking, electrical, strangulation, injury, or other type of hazard.
- DO NOT make adjustments to the seat height while child is in the chair.
- NEVER place the chair near fire or open flame nor other sources of intense heat.
- DO NOT use the high chair if any parts or hardware are broken or missing.

# Parts List

**A**

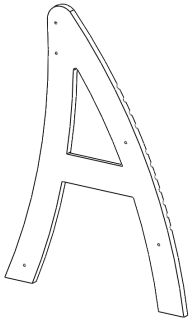

1x Left Side

**B**

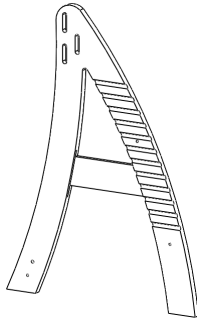

1x Right Side

**C**

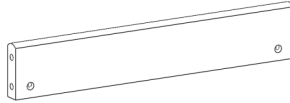

1x Bottom Rail

**D**

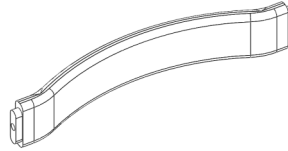

2x Curved Back Rail

**E**



1x Curved Front Rail

**F**

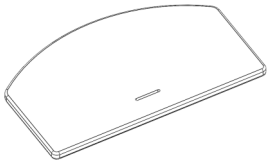

1x Seat Platform

**G**

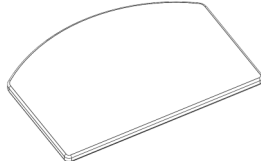

1x Foot Rest Platform

**H**

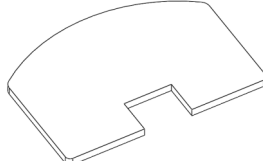

1x Seat Cushion

**J**

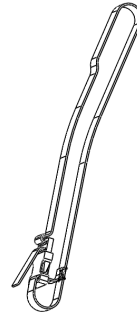

1x Crotch Restraint Belt  
See Steps 2 & 4 for information

**K**

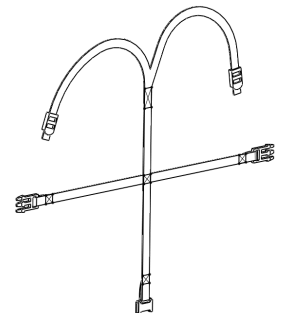

1x 5 Point Seat Harness

**L**

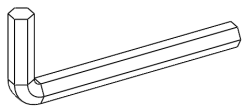

1x Allen Wrench  
SAVE FOR FUTURE USE!

**M**

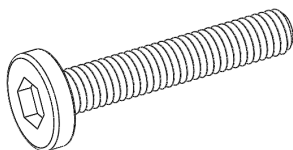

8x M6 x 35 Bolts

**N**

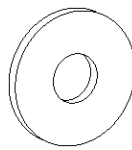

10x Washer

**P**

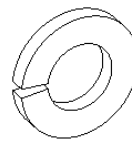

10x Spring Washer

**S**

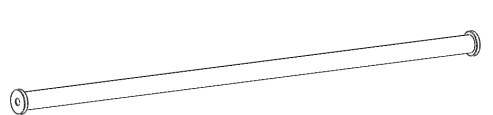

2x Connecting Rod

**T**

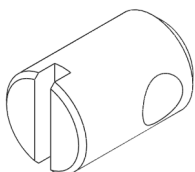

2x Barrel Nut

**U**

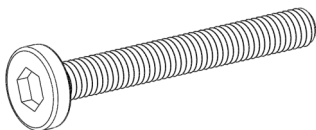

2x M6 x 50 Bolts

# Assembly Overview

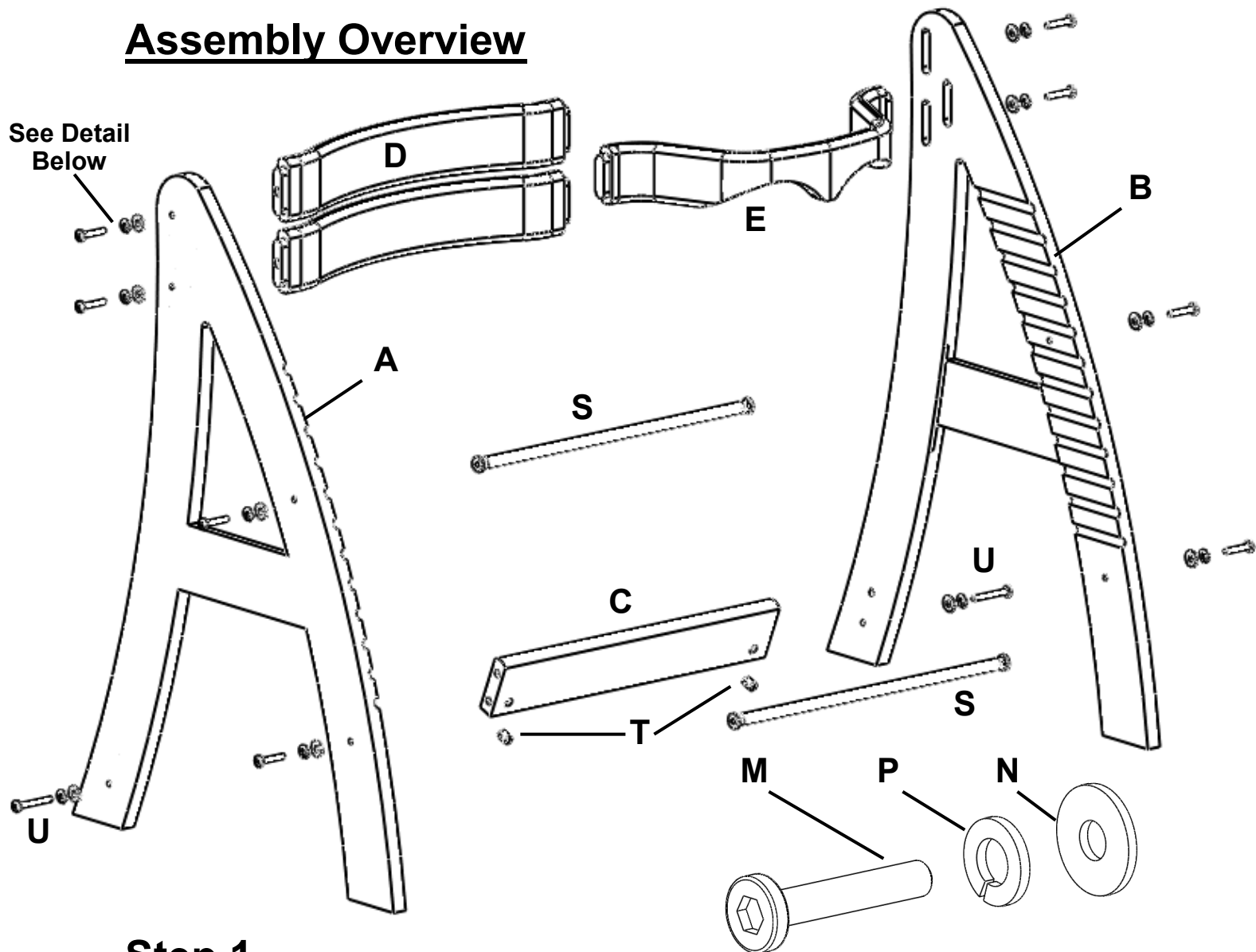

## Step 1

Attach one end of **CONNECTING ROD (S)** into **LEFT** or **RIGHT** side panels (**A** or **B**).

Insert the **Screw (M)**, **Spring Lock Washer (P)**, and **Washer (N)** thru the side panel and hand tighten.

**NOTE: DO NOT** fully tighten screws at this time.

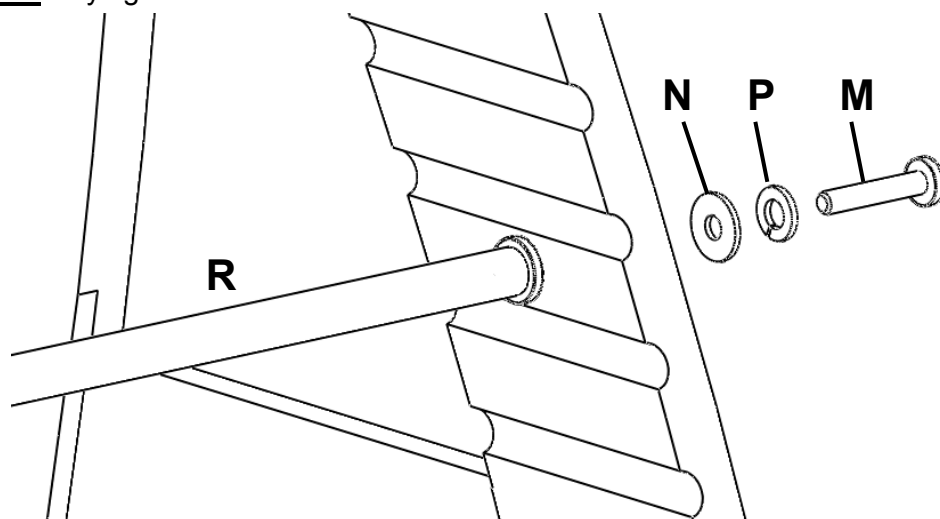

## **Step 2**

Install **CROTCH RESTRAINT BELT (J)** over Connecting Rod (R) and then snap the opposite end of **CONNECTING ROD (S)** into remaining side panel (**A** or **B**).

Insert the **Screw (M)**, **Spring Lock Washer (P)**, and **Washer (N)** thru the side panel and hand tighten.

**NOTE: DO NOT** fully tighten screws at this time.

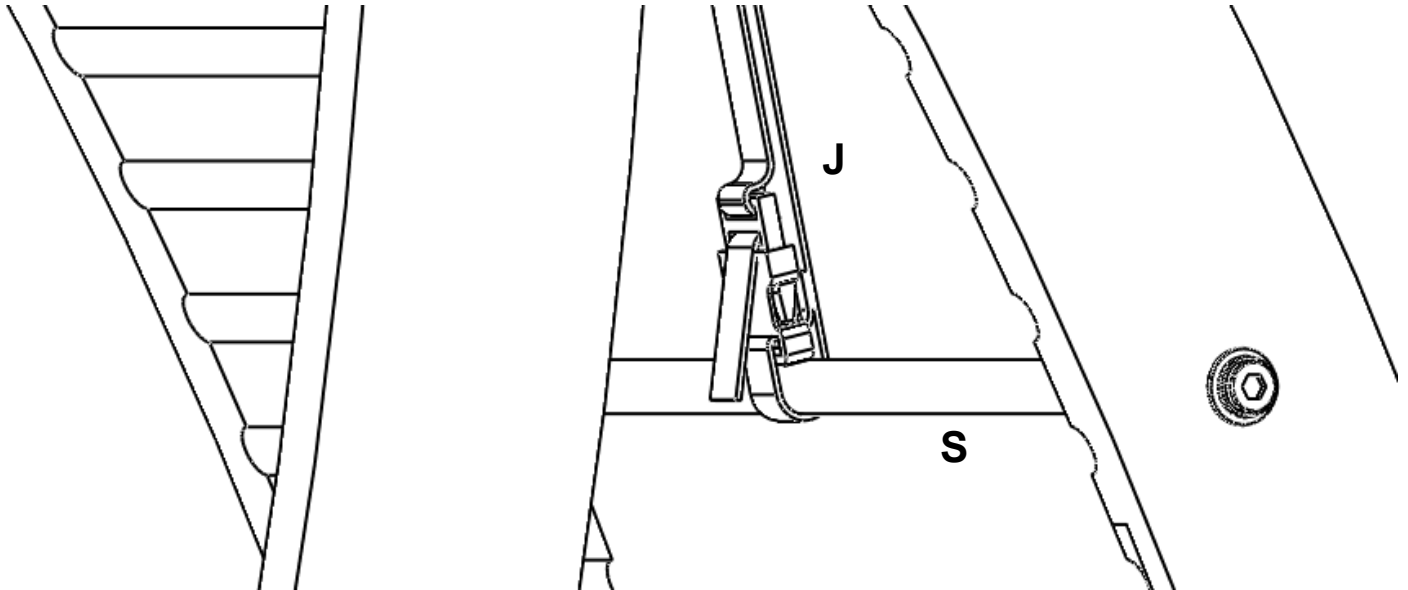

## **Step 3**

Install **BARREL NUT (T)** into **BOTTOM RAIL (C)**, make sure that hole in Barrel Nut is aligned with hole in the end of the Bottom Rail to accept Screw (U).

Install the **CURVED BACK RAILS (D)** and **BOTTOM RAIL (C)** into side panels (**A** and **B**).

Insert the **Screw (M)**, **Spring Lock Washer (P)**, and **Washer (N)** thru the side panel and hand tighten.

**NOTE: DO NOT** fully tighten screws at this time.

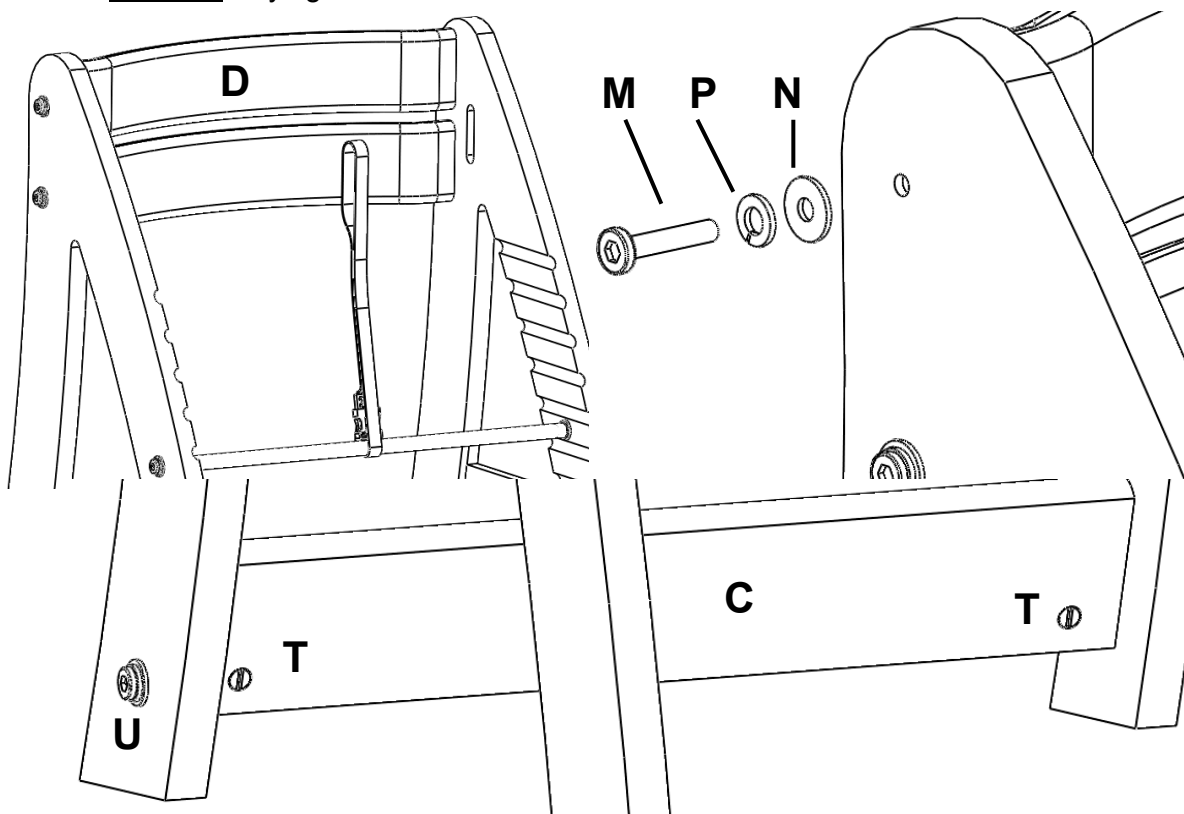

## **Step 4**

Install **SEAT PLATFORM (F)** in the topmost seating position. The Seat Platform **MUST** be pushed back until it stops and will not slide in any further. Pass **CROTCH RESTRAINT BELT (J)** thru Seat Platform (F) and then thru **CURVED FRONT RAIL (E)**.

Install the **CURVED FRONT RAIL (E)** into the pockets of the side panels (**A** or **B**).

**NOTE:** The **5 POINT SEAT HARNESS (K)** is pre-attached to the SEAT PLATFORM (F). It is not shown in the diagrams because no assembly is needed except you must review the proper use of the harness detailed on the last page or the instructions.

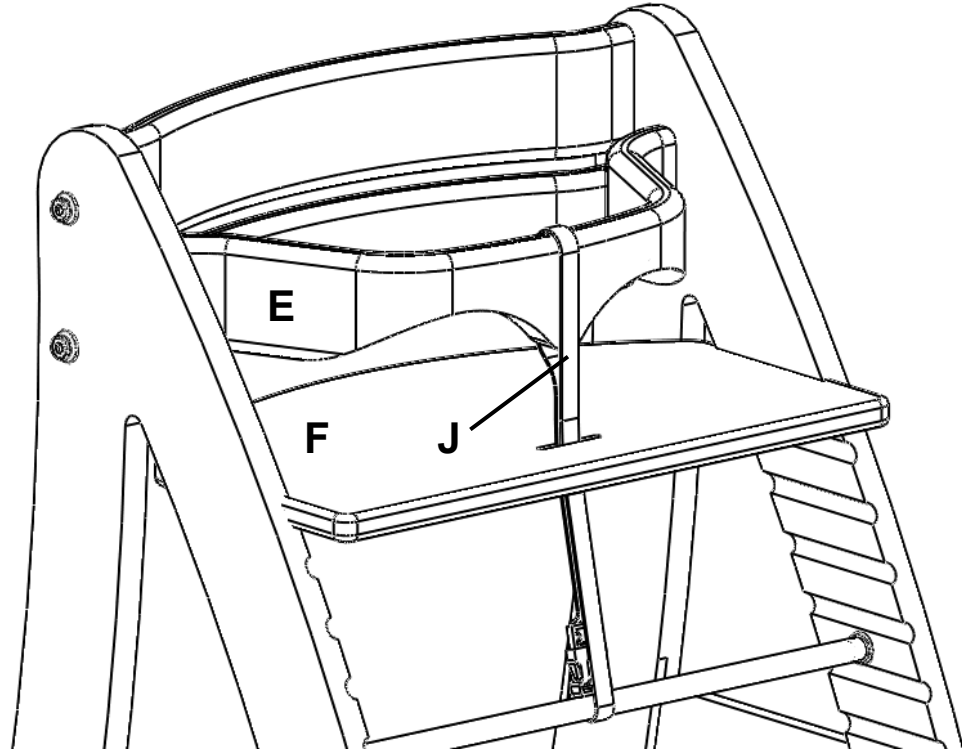

## **Step 5**

Install the bottom **CONNECTING ROD (S)**.

Insert the **Screw (M)**, **Spring Lock Washer (P)**, and **Washer (N)** thru the side panel and hand tighten.

**NOTE:** **DO NOT** fully tighten screws at this time.

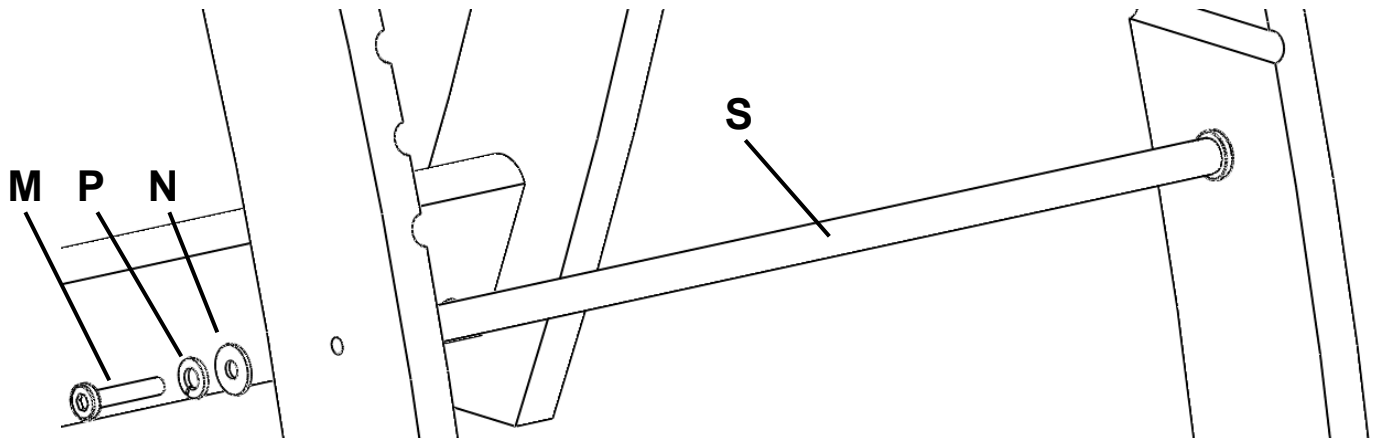

## **Step 6**

Install the **FOOTREST PLATFORM (G)** in one of the lower positions.

Footrest Platform **MUST** be inserted so at least 2-1/2 inches stick out the back.

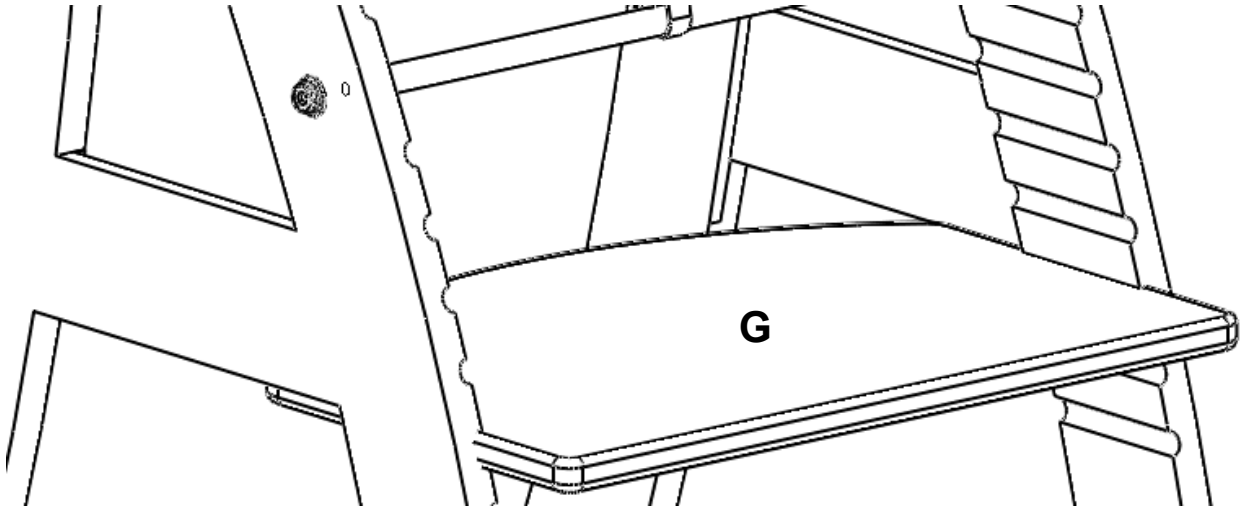

## **Step 7**

Put the chair into an upright position on a flat and level surface. Level the chair and then securely tighten **ALL** of the bolts!

### **IMPORTANT:**

**DO NOT DISCARD THE ALLEN WRENCH.**

**You MUST regularly check the bolts and retighten as needed using the ALLEN WRENCH included with the chair! Check and retighten 1-2 weeks after initial assembly. Thereafter, check on all bolts on at least a monthly basis.**

As your child grows you can loosen the bolts to change the position of the seat and foot rest platforms. Be sure to level the chair and then retighten the bolts securely whenever adjustments are made.

If the Seat Platform is in any slot other than the top one, you must remove and not use the Curved Front Rail and Crotch Restraint Belt.

# PROPER USE OF THE 5 POINT SEAT HARNESS:

SEE FIGURE A (BELOW)

When your child is sitting in the high chair, the shoulder straps (3) come up **BEHIND** the chair and **OVER THE TOP OF** the CURVED BACK RAILS and then down over the child's shoulders to hook to the harness buckle in front.

The waist straps (4) go around the child's waist and snap into the harness buckle in front, and the crotch strap (5) will rest beneath the child and between the legs.

The CROTCH RESTRAINT BELT in FIGURE A was moved out of the way and the CURVED FRONT RAIL is shown as transparent so the 5-POINT SEAT HARNESS could be shown clearly. It is essential that you install the CROTCH RESTRAINT BELT per the instructions and do not leave it out; and only use the CURVED FRONT RAIL and CROTCH RESTRAINT BELT with the seat in the TOP position as noted in

**FIGURE A**

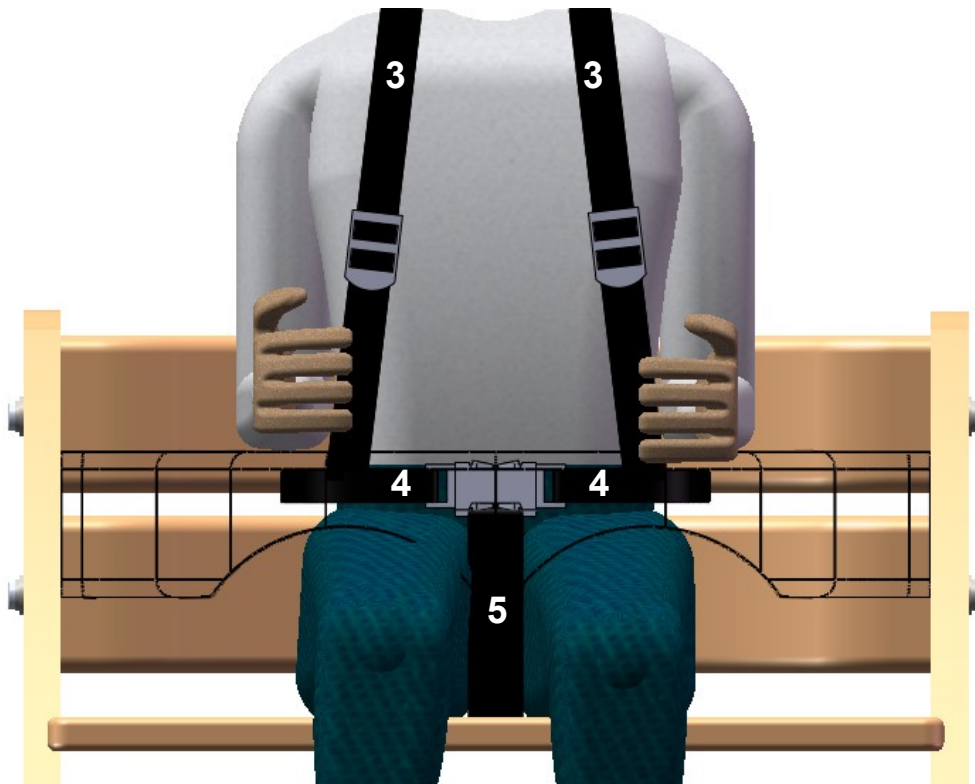

## CARE INSTRUCTIONS:

Wipe the straps and seat cushion with a damp cloth after each use; periodically wipe down the chair with a damp cloth and mild detergent.