

**OneStepAhead<sup>®</sup>**  
**EURO II**  
**GROW WITH ME CHAIR**



**Assembly Instructions.**  
**Adult Assembly Required.**  
**Read all instructions before use.**  
**Save instructions for future use.**

Never use with missing parts or hardware.

**MODEL #22169**

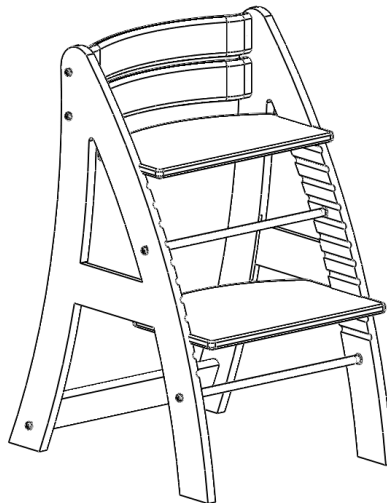

**OneStepAhead<sup>®</sup>**

75 Albrecht Drive  
Lake Bluff, IL 60044  
1-800-950-5120  
[www.onestepahead.com](http://www.onestepahead.com)

### **CARE INSTRUCTIONS:**

Wipe the seat cushion with a damp cloth after each use;  
Periodically wipe down the chair with a damp cloth and mild detergent.



**WARNING! FAILURE TO FOLLOW THESE WARNINGS AND THE INSTRUCTIONS MAY RESULT IN SERIOUS INJURY OR DEATH. NEVER LEAVE CHILD UNATTENDED.**

- REGULARLY check the bolts and retighten as needed using the included wrench.
- READ ALL INSTRUCTIONS before use of this product. Keep instructions for future use.
- Use only the parts and hardware provided.
- Hardware may include small parts.
- Choking Hazard! Keep unassembled parts out of the reach of small children.
- Chair is for use from three (3) years or age and up.
- ALWAYS keep your child in view while in the chair.
- Never leave your child unattended, not even for “just a minute”
- No product is a replacement for adult supervision.
- Once the chair is assembled and all the bolts are tightened, the seat and footrest platforms SHOULD NOT HAVE ANY MOVEMENT front to back or side-to-side.
- If your seat and/or footrest is NOT FIRMLY HELD IN POSITION, DO NOT USE THE CHAIR until you have contacted One Step Ahead for assistance.
- DO NOT allow anyone to climb, stand on, or play on or inside of this product. It is not a step stool or ladder.
- ALWAYS ensure the chair is on a flat and level surface.
- BE AWARE of what items are in the area around the chair which your child can reach, grab, or pull that could be a choking, electrical, strangulation, injury, or other type of hazard.
- DO NOT make adjustments to the seat height while child is in the chair.
- NEVER place the chair near fire or open flame nor other sources of intense heat.
- DO NOT use the high chair if any parts or hardware are broken or missing.

# Parts List

**A**

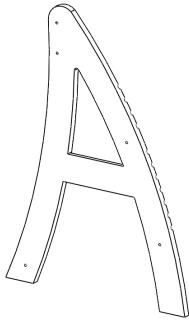

1x Left Side

**B**

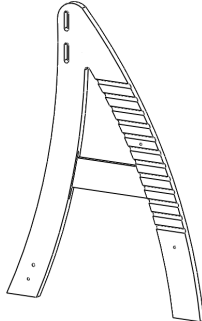

1x Right Side

**C**

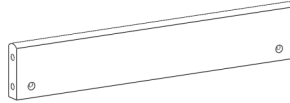

1x Bottom Rail

**D**

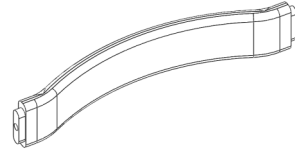

2x Curved Back Rail

**E**

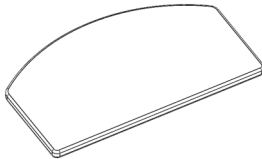

1x Seat Platform

**F**

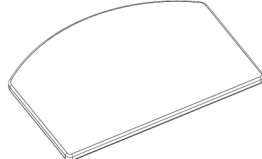

1x Foot Rest Platform

**G**

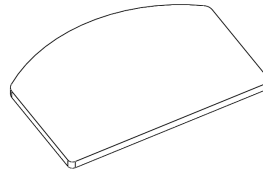

1x Seat Cushion

**H**

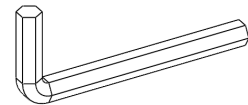

1x Allen Wrench  
SAVE FOR FUTURE USE!

**J**

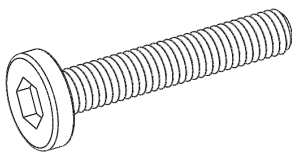

8x M6 x 35 Bolts

**K**

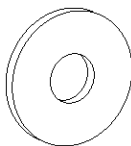

10x Washer

**L**

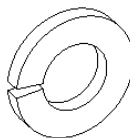

10x Spring Washer

**N**



1x Connecting Rod

**P**

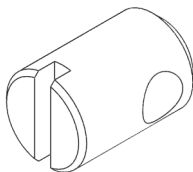

2x Barrel Nut

**Q**

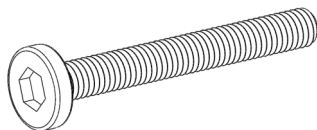

2x M6 x 50 Bolts

## Assembly Overview

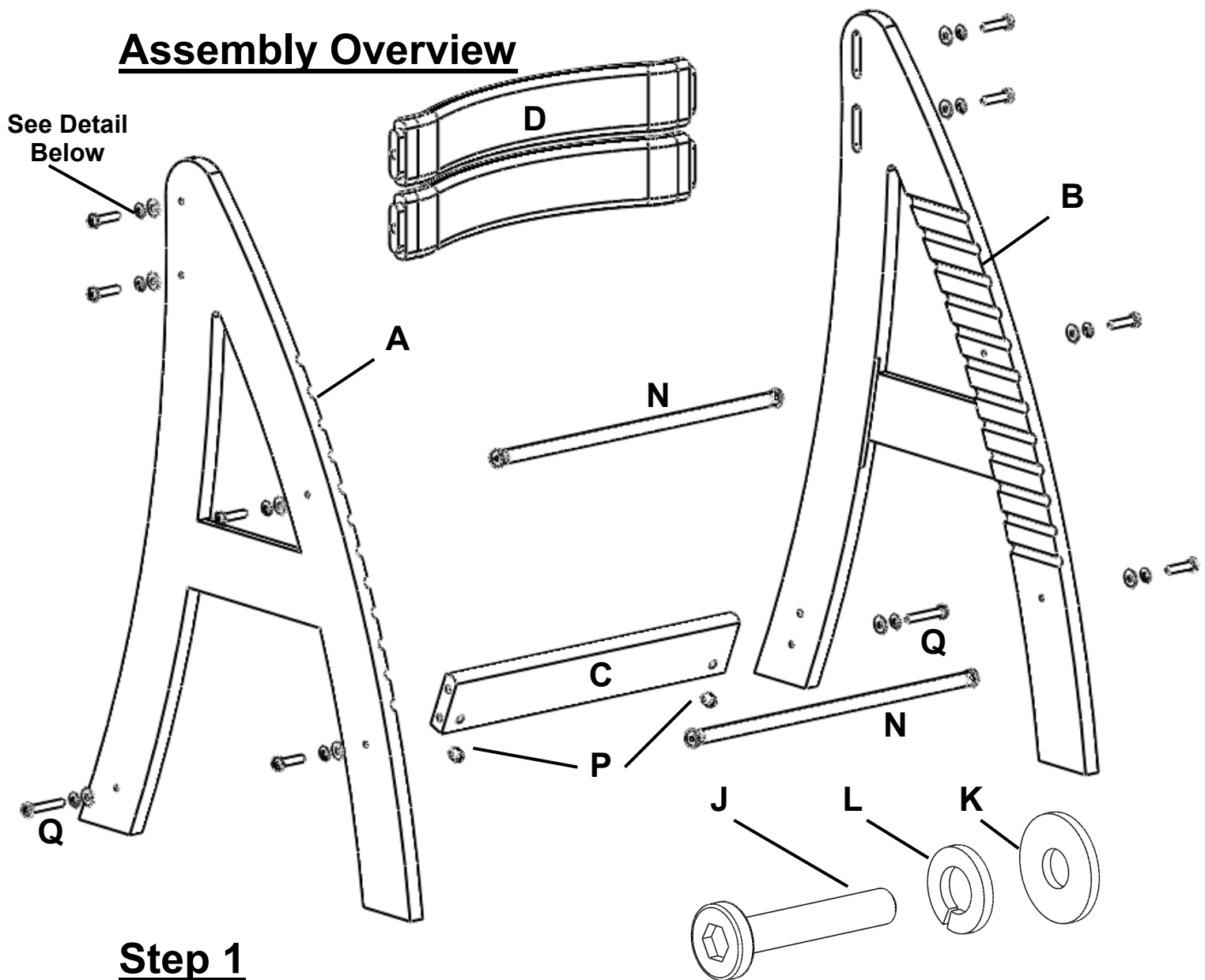

### Step 1

Attach one end of **CONNECTING ROD (N)** into **LEFT** or **RIGHT** side panels (**A** or **B**).

Insert the **Screw (J)**, **Spring Lock Washer (L)**, and **Washer (K)** thru the side panel and hand tighten.

**NOTE: DO NOT** fully tighten screws at this time.

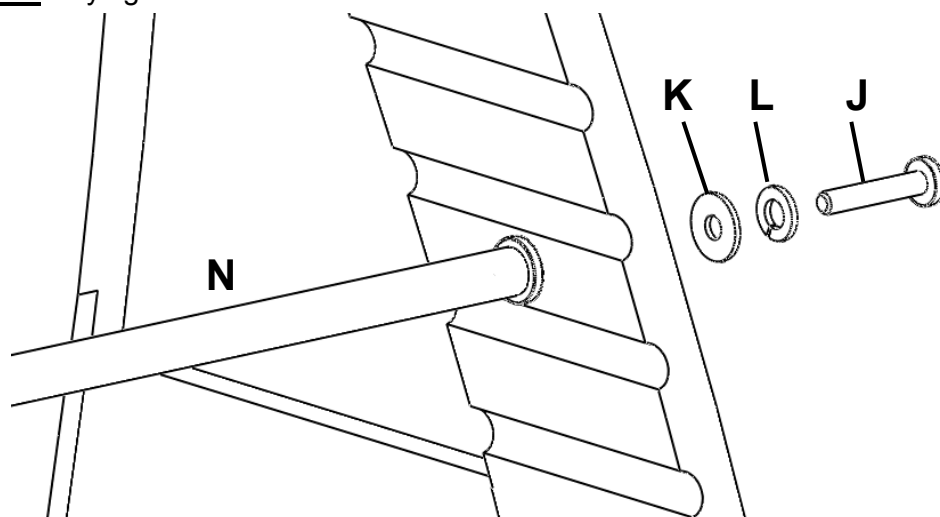

## **Step 2**

Attach the opposite end of **CONNECTING ROD (N)** into remaining side panel (**A** or **B**).

Insert the **Screw (J)**, **Spring Lock Washer (L)**, and **Washer (K)** thru the side panel and hand tighten.

**NOTE: DO NOT** fully tighten screws at this time.

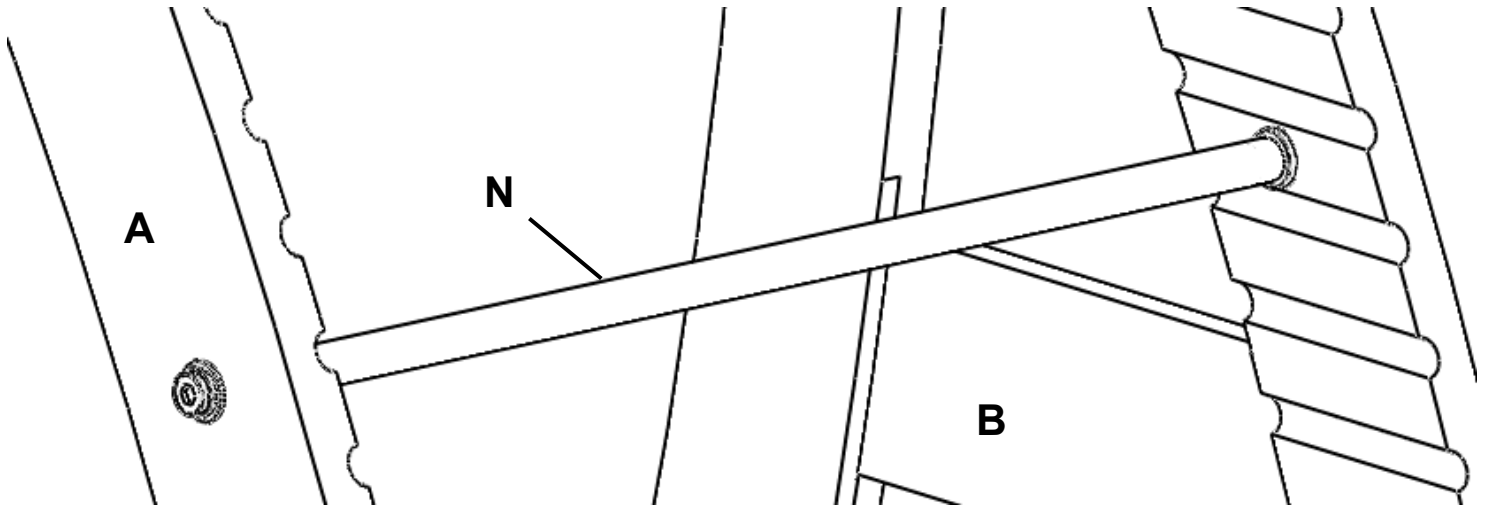

## **Step 3**

Install **BARREL NUT (P)** into **BOTTOM RAIL (C)**, make sure that hole in Barrel Nut is aligned with hole in the end of the Bottom Rail to accept Screw (Q).

Install the **CURVED BACK RAILS (D)** and **BOTTOM RAIL (C)** into side panels (**A** and **B**).

Insert the **Screw (J)**, **Spring Lock Washer (L)**, and **Washer (K)** thru the side panel and hand tighten.

**NOTE: DO NOT** fully tighten screws at this time.

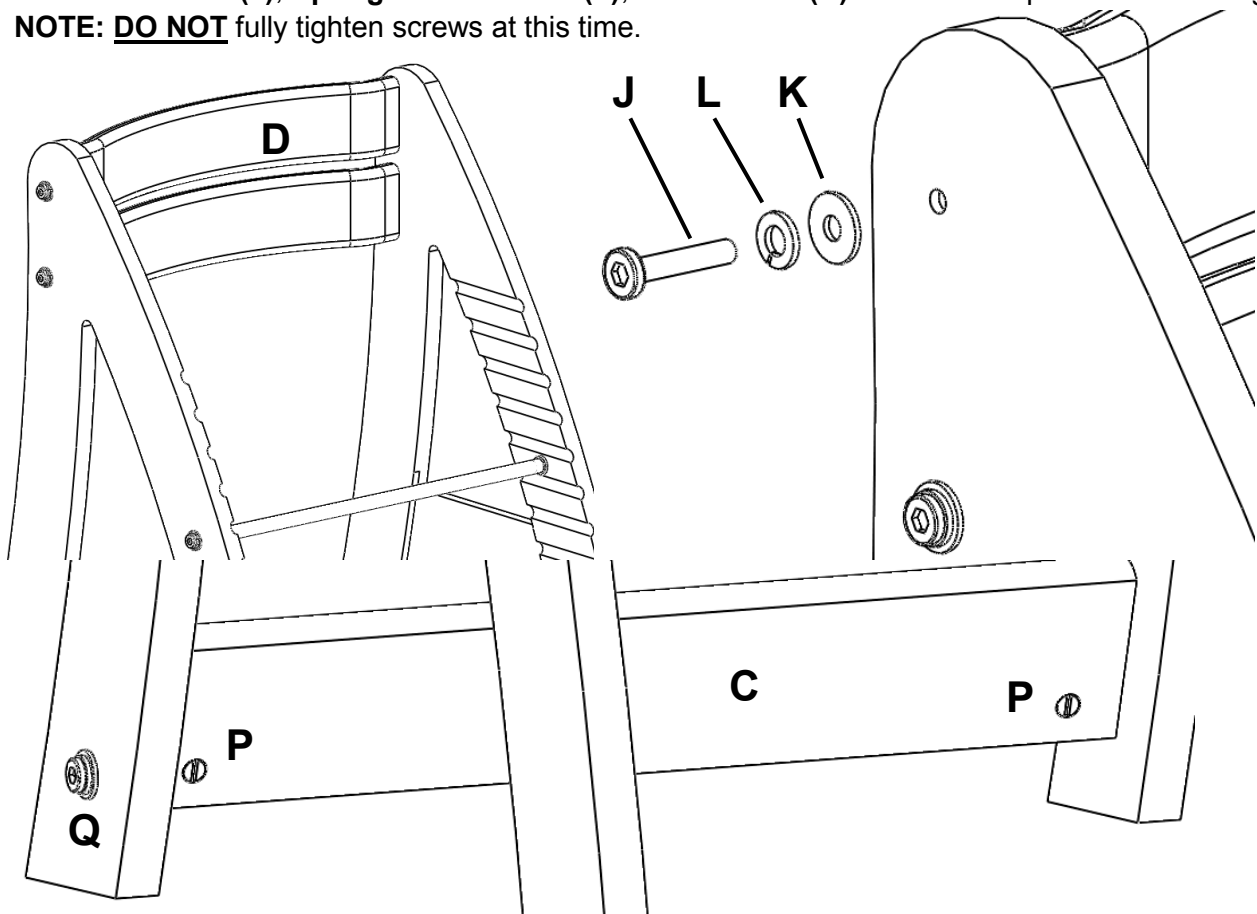

## **Step 4**

Install the **CONNECTING ROD (N)**.

Insert the **Screw (J)**, **Spring Lock Washer (L)**, and **Washer (K)** thru the side panel and hand tighten.

**NOTE: DO NOT** fully tighten screws at this time.

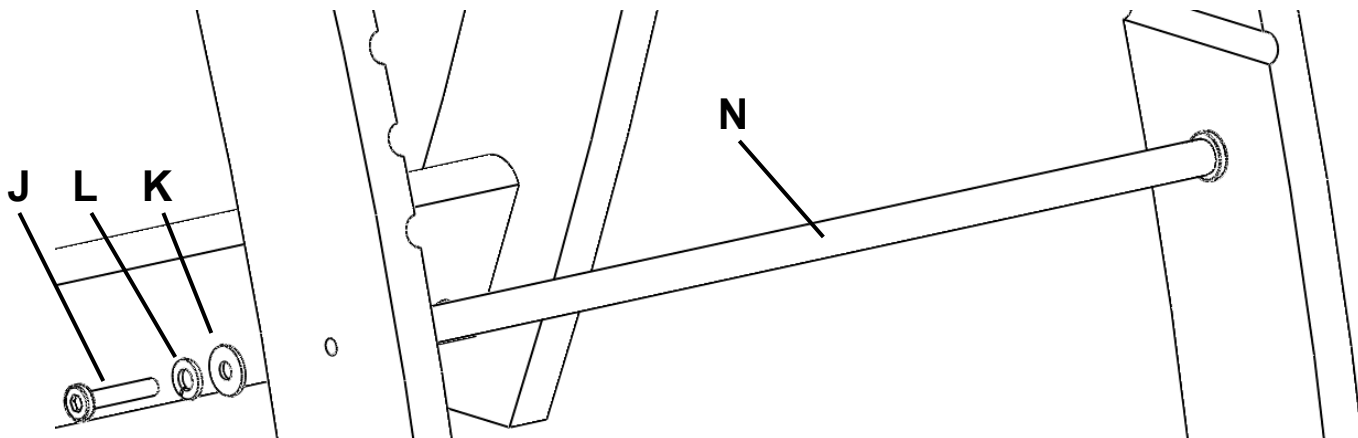

## **Step 5**

Install **SEAT PLATFORM (E)** in the topmost seating position. The Seat Platform **MUST** be pushed back until it stops and will not slide in any further.

Install the **FOOTREST PLATFORM (F)** in one of the lower positions. Footrest Platform **MUST** be inserted so at least 2-1/2 inches sticks out the back.

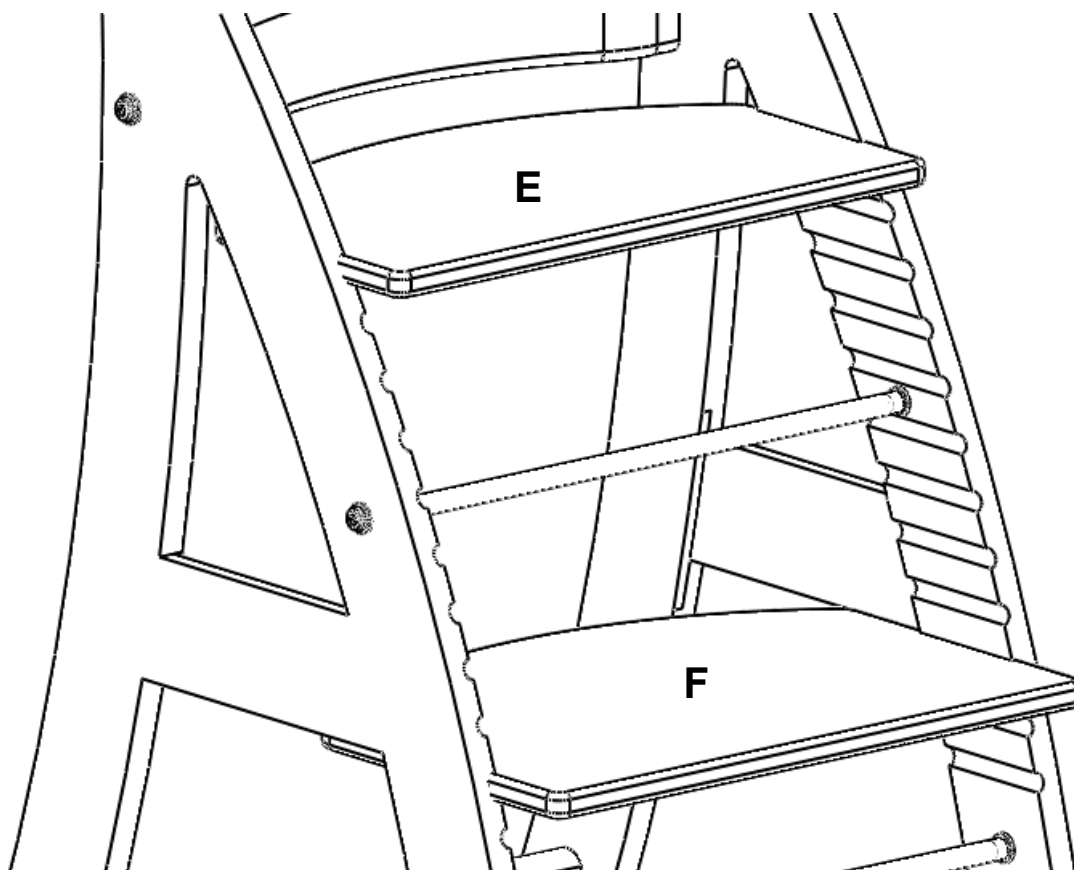

## **Step 6**

Put the chair into an upright position on a flat and level surface. Level the chair and then securely tighten **ALL** of the bolts!

**IMPORTANT:**

**DO NOT DISCARD THE ALLEN WRENCH.**

**You MUST regularly check the bolts and retighten as needed using the ALLEN WRENCH included with the chair! Check and retighten 1-2 weeks after initial assembly. Thereafter, check on all bolts on at least a monthly basis.**

As your child grows you can loosen the bolts to change the position of the seat and foot rest platforms. Be sure to level the chair and then retighten the bolts securely whenever adjustments are made.