



## 4 In 1 Kitchen Master Model # DKM9801



### Instruction Manual

Thank you for purchasing your Ginny's Brand 4 in 1 Kitchen Master! Hope you love it as much as we do!

[www.ginnys.com](http://www.ginnys.com)

## **IMPORTANT SAFEGUARDS**

When using electrical appliances, basic safety precautions should always be followed to reduce the risk of fire, electric hazard and injury to persons, including the following.

1. Carefully read these instructions before using your appliance.
2. Keep out of reach of children.
3. **BEFORE USING THE FIRST TIME:** Before using the product for the first time, remove all attachments from their packaging. Wash all accessories and shaft. Dry with a clean dry towel.
4. **VERY IMPORTANT:** Do not immerse in water or other liquids or use near wash basins or sinks. Ensure that the appliance does not get wet (water splashes etc.) and do not use it with wet hands.
5. An appliance dropped or damaged should not be used, if damaged or defective, call our toll-free number.
6. Do not permit the power cord to come in contact with hot objects.
7. An appliance should never be left unattended when plugged in.
8. Unplug from Mains outlet when appliance is not in use, in storage, before attaching or removing accessories, and before cleaning.
9. Use this appliance only for its intended use. Use only the attachments supplied with this product.
10. The appliance should not be used outdoors, placed near a hot gas or electrical burner or placed in a heated oven.
11. Do not let cord hang over edge of table or counter.
12. Blades are sharp. Handle carefully. Always handle blades with hand away from cutting edge. Always store blades with cutting edge away from you.
13. Do not attempt to cut through bones or frozen products.
14. Do not attempt to cut through food that is on a metal or ceramic surface.
15. Do not plug the appliance into an outlet where another high wattage appliance is being used.
16. K.B.2 minutes (K.B. means that this appliance is designed for short periods of operation only). Do not continuously operate the appliance for periods in excess of 2 minutes. If the appliance is being used for periods of up to 2 minutes, allow 10 minutes cooling time before continuing.
17. You can switch the appliance on for a maximum of one minute continuous operation, then allow the appliance to rest for at least one minute before using again.
18. This appliance is intended for household use only and not for commercial or industrial use.
19. No liability can be accepted for any damage caused by non-compliance with these instructions or any other improper use or mishandling.
20. If the power cord is damaged, do not use the appliance. Call our toll-free number.

## **SAVE THESE INSTRUCTIONS HOUSEHOLD USE ONLY**

**This appliance has a polarized plug (one blade is wider than the other). To reduce the risk of electric shock, this plug is intended to fit into a polarized outlet only one way. If the plug does not fit fully into the outlet, reverse the plug. If it still does not fit, contact a qualified electrician. Do not attempt to modify the plug in any way.**

## PART LIST



1. CUP COVER
2. CHOPPING BLADE
3. CHOPPING CUP
4. BASE
5. BLENDER ATTACHMENT
6. STAINLESS STEEL WHISK
7. WHISK ATTACHMENT BASE
8. DUAL STAINLESS STEEL BEATERS
9. DUAL BEATER ATTACHMENT BASE
10. UNIT COVER
11. UNIT SWITCH--HANDLE
12. UNIT SWITCH
13. MAIN UNIT
14. MEASURING CUP
15. MOUNTING BRACKET
16. EXPANDING INSERT
17. SELFTAPPING SCREW

## INSTALL THE BLENDING, WHISK, DUAL BEATERS AND CHOPPING ATTACHMENT

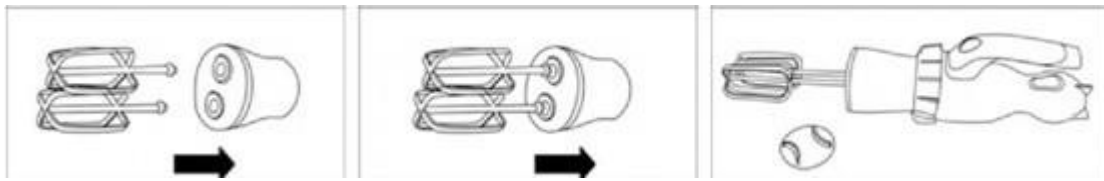

Insert the double beaters into the beater attachment base. Screw down the unit cover from the main unit and screw the beater base into the main unit.

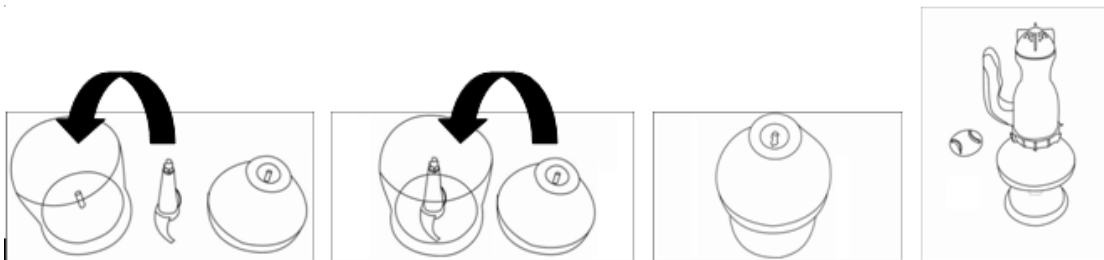

Put the chopping blade into the chopping cup, then screw the chopping cup cover to the chopping cup. Screw down the unit cover from the main unit and screw the main unit to the chopping cup.

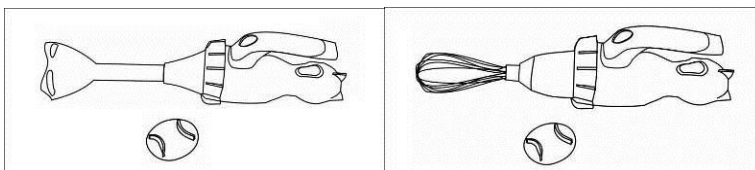

Screw down the unit cover from the main unit, screw the blender attachment or stainless steel whisk & whisk attachment base to the main unit.

## MOUNTING THE BASE TO THE WALL:

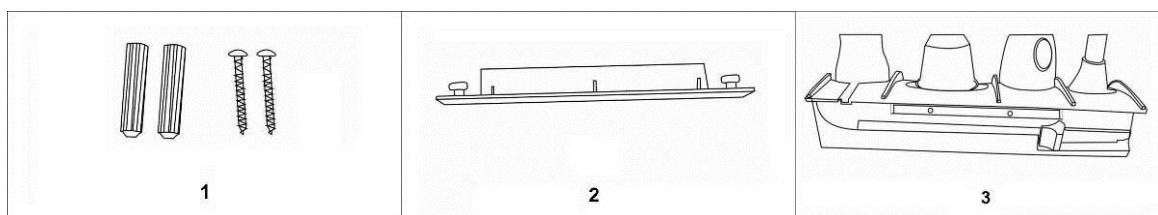

1. Use a pencil to mark two points on the wall where you would like to mount the unit. Make sure the two points are in a horizontal level line, drill two holes on the two points marked on the wall.
2. Hammer the expanding inserts into the two holes, use a Phillips screwdriver to fix the mounting bracket to the wall by twisting the self tapping screw through two holes of the mounting bracket into the expanding inserts.
3. Put the base onto the mounting bracket.

## OPERATION

### Using the chopping cup and chopping blade attachments:

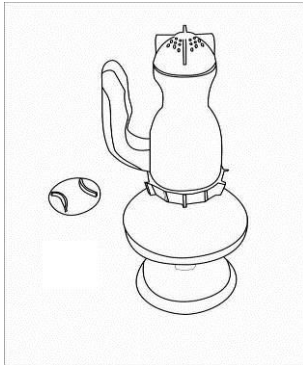

Suitable food: Fresh vegetables, cut it into flakes or pieces about 1"X1", Put 0.44lbs vegetable into the chopping cup, screw the chopping cup to the main unit and close the lid then start operation about 15 seconds ( see the left picture ) .

### SHARP BLADES-HANDLE CAREFULLY

1. To operate the blade, press the switch with your thumb.
2. To cut the food, simply guide the blades through the food. It is not necessary to move the blades, as the double cutting action of the two blades will slice the food quickly, easily and neatly. To cease cutting, release pressure from the switch which automatically turns the appliance off.

### Using the Blending, Whisk and Dual Beaters

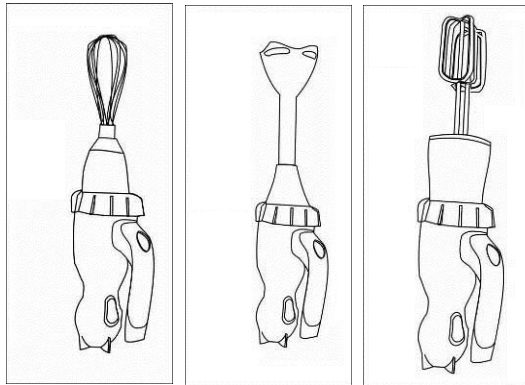

NOTICE: THE MEASURE CUP COULD ONLY BE MATCHED WITH THE BLENDING ATTACHMENT, OTHERWISE IT WILL BE BROKEN.

Suitable food: cut carrots into pieces of 1/2"X1/2", and put 5 ounces into the measuring cup with 16 fluid ounces water, then start operation about 30 seconds.

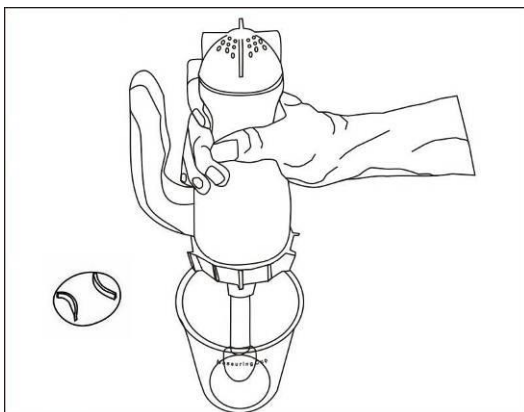

**SHARP BLADES-HANDLE CAREFULLY**

1. Complete the installation of the stainless steel blending or whisk attachment into the main unit motor housing.
2. Plug the electrical cord into the appropriate electrical wall outlet.
3. Insert the stainless steel blending or whisk attachment into mixture for blending.
4. Turn power on by pressing and holding the silver buttons in the aft of the motor body. The button must be pressed for power, the unit will shut off once the button is released.
5. When blending is complete release power button before removing blender from mixture.
6. Make sure unit is off and unplugged from power source before removing attachments.

**CLEANING INSTRUCTIONS**

1. To clean the outer surface of chopping blade, use a soft damp cloth and dry it afterwards with a dry towel. Clean only after unplugging the chopping blade from the mains supply.
2. Never use metal polish.
3. The blade is factory lubricated and requires no further lubrication.
4. Wash blender attachment, whisk attachment base, dual beater attachment base and chopping cup & cup cover with warm soapy water.
5. The chopping blade, the stainless steel whisk, the dual beaters and the measuring cup are dishwasher safe.

**Warning:**

The appliance is not to be used by children or persons with reduced physical, sensory or mental capabilities, or lack of experience and knowledge, unless they have been given supervision or instruction. Be sure children are being supervised not to play with the appliance.

When using electrical appliances, basic safety precautions should always be followed including the following:

- 1) Unplug from outlet when not in use, before putting on or taking off parts, and before cleaning.
- 2) Avoid contacting moving parts.
- 3) Do not let cord contact hot surface, including the stove. Do not operate knife in water or under running water. Disconnect when changing blades.

Blades are sharp. Handle carefully. Always handle blades with hand away from cutting edge. Always store blades with cutting edge away from you

- 4) Keep hands and utensils away from the cutting blade while chopping food to reduce the risk of severe injury to persons or damage to the food chopper. A scraper may be used but only when the food chopper is not running.
- 5) Blade is sharp. Handle carefully.

- 6) To reduce the risk of injury, never place cutting blade on base without first putting bowl properly in place.
- 7) Be certain cover is securely locked in place before operating appliance.
- 8) Do not attempt to defeat the cover interlock mechanism.
- 9) When mixing liquids, especially hot liquids, use a tall container or make small quantities at a time to reduce spillage.
- 10) Keeps hands and utensils out of the container while blending to prevent the possibility of severe injury to persons or damage to the unit. A scraper may be used but must be used only when the unit is not running.

### **1 YEAR LIMITED WARRANTY**

Ginny's warrants this product free from defects in material and workmanship for one year from provable date of purchase.

Within this warranty period, Ginny's will repair or replace, at its option, defective parts at no charge, provided the product is returned, freight prepaid with proof of purchase to Ginny's. Allow 2-4 weeks for return shipping.

This warranty does not cover improper installation, misuse, abuse or neglect on part of the owner. Warranty is also invalid in any case that the product is taken apart or serviced by an unauthorized service station.

This warranty gives you specific legal rights and they may vary from state to state.

THE FOREGOING WARRANTIES ARE IN LIEU OF ALL OTHER WARRANTIES AND CONDITIONS, EXPRESS OR IMPLIED, INCLUDING BUT NOT LIMITED TO THOSE OF MERCHANTABILITY OR FITNESS FOR A PARTICULAR PURPOSE.

### **GINNY'S Customer Returns**

Phone: 800-544-1590  
8:00 am to Midnight, Monday through Friday

[www.ginnys.com](http://www.ginnys.com)

---