



# Mini Chopper Instruction Manual

Item 62452



Ginnys.com • 1.800.544.1590

Thank-you for purchasing a Ginny's Brand Mini Chopper! A small and lightweight dynamo, it powers through every-day dicing, chopping and prepping, saving you time—and the bother of lugging out your food processor. Its stainless steel blades easily chop veggies and herbs, grind nuts and hard cheeses, and whirl together delicious dips, sauces and dressings—all in a flash. Better cooking AND better eating start now. Enjoy!

## TABLE OF CONTENTS

Important Safeguards	3
Specifications	4
Part Names	5
How to Operate	6-7
Cleaning & Care	7
Warranty	8

## IMPORTANT SAFEGUARDS

When using your mini chopper, basic safety precautions must always be followed, including the following:

1. Read all instructions carefully.
2. Always unplug the product from the electrical outlet when not in use, before putting on or taking off parts, and before cleaning.
3. Keep the power cord and product away from heated surfaces.
4. Do not place the power unit in or expose it to water or other liquids.
5. Do not use attachments not recommended or sold by the product manufacturer.
6. Avoid contact with moving parts.
7. Handle the blades with care as they are extremely sharp. Use caution when attaching or detaching the blades.
8. Always assemble the product completely before plugging it into an electrical outlet.
9. Before disassembling/reassembling the product, unplug it from the electrical outlet and ensure the metal shaft and blades have completely stopped.
10. Do not plug or unplug the product into/from the electrical outlet with a wet hand.
11. To disconnect from an electrical outlet, pull directly on the plug; do not pull on the power cord.
12. Do not operate the product if it has a damaged power cord or plug, malfunctions, or is dropped or damaged. Do not attempt to repair this product yourself. Call our Ginny's customer service toll-free number for information regarding repair or replacement.
13. Do not place the appliance near any hot surfaces.
14. Never put power unit into water or other liquid.
15. This product is intended for indoor, household use only. Do not use outdoors.
16. This product is intended for use in chopping foods for human consumption. Do not use the product for any other purpose.
17. Keep the product out of the reach of children and pets. This product is not intended for use by children. Close supervision is necessary when any appliance is used by or near children.
18. Always place the product on a flat, level, heat-resistant surface.
19. Do not let the cord hang over the edge of the table or counter.

## PART NAMES

No user-serviceable parts inside. A short cord is provided to reduce the hazards resulting of entanglement or tripping over a long cord. An extension cord may be used with care, however, the marked electrical rating should be at least as great as the electrical rating of this appliance. The extension cord should not be allowed to drape over the counter or tabletop where it can be pulled on by children or tripped over.

### FOR HOUSEHOLD USE ONLY

This mini chopper is equipped with a polarized plug in which one prong is wider than the other. This is a safety feature, to reduce the risk of electrical shock. The plug will fit into a polarized outlet only one way. If you are unable to insert the plug into the electrical outlet, try reversing the plug. If the plug still does not fit, contact a qualified electrician. Do not attempt to modify the plug in any way.

### SPECIFICATIONS

Product Size:	6" Diam. x 8" H
Power Rating:	120V 60Hz
Wattage:	200W
Cord Length:	32"
Capacity:	25 oz.

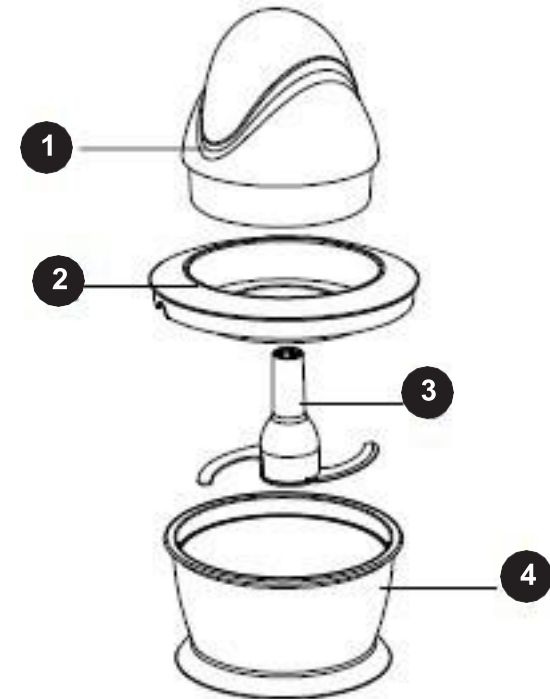

1. Power Unit
2. Mounting Plate
3. Blade
4. Plastic Bowl

## HOW TO OPERATE

1. Before first use, wash the bowl, mounting plate and blade in warm, soapy water.
2. Place the blade onto the blade supporting pin in the bowl.
3. Fill the ingredients inside the bowl. Do not overfill.
4. Place the mounting plate on the bowl.
5. Place the power unit on the assembled plate-bowl and twist it slightly until the blade fits into the power unit.
6. Plug the cord into an outlet.
7. Hold the bowl with one hand and press down on the power unit with the other hand. The appliance will begin to run.

**WARNING:** This appliance is intended for a maximum operation cycle of 20 seconds ON and minimum 2 minutes OFF, Do not exceed 3 cycles. A longer break of about 30 minutes is necessary in order to allow the appliance cool down.

8. Unplug the appliance, and wait for the blade to stop completely, before disassembly.
9. Remove the power unit, the mounting plate and the blade

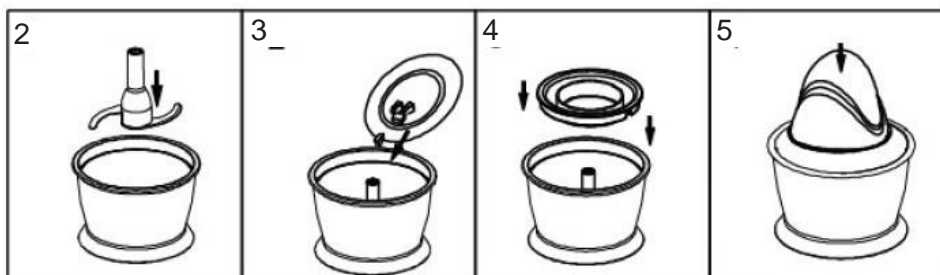

### HELPFUL HINTS

1. Be sure to put the blades into place before filling unit with food.
2. If blade does not move freely anymore or stop suddenly, immediately release the start button, disassemble and remove the obstruction.
3. If blade does not reach full speed instantly, stop and remove some of the food.
4. Pulse action is used for moist or soft ingredients. Each pulse action is approximately a half-second.
5. Even chopping is achieved by using uniformly sized pieces of food.

### WARNING:

1. Do not take off the plate before the blade has completely stopped.
2. Always operate the unit with the cover in position.
3. Always unplug power unit before cleaning and after use.
4. Do not use the appliance when it is empty.

## OPERATING TIME GUIDE

INGREDIENT	MAX QUANTITY	MAX TIME
Onions	2 oz.(cut in 8)	4-8 sec. in pulse
Fruit	1-3/4 oz.	8 sec.
Garlic	1-3/4 oz.	4-8 sec. in pulse
Biscuits	1/2 oz.	12 sec.
Cheese	1 oz.	12 sec.
Almonds	1 oz.	12 sec.
Hazelnuts	1 oz.	12 sec.
Walnuts	1 oz.	12 sec.
Hard Boiled Eggs	2 yolks	4-8 sec. in pulse
Meat	1-3/4 oz.	8 sec.
Ham	1-3/4 oz.	8 sec.

**Note:** Maximum bowl capacity: 25 oz.

## CLEANING & CARE

1. Always unplug before cleaning.
2. Do not wash the parts in a dishwasher.
3. Clean the exterior surface of the power unit by wiping it with a soft, damp cloth.
4. Blade can be washed using warm, soapy water. Caution: blade is very sharp.
5. Wash the others parts with a mild detergent, warm water and a soft cloth or sponge. Do not use abrasive cleaners, they will damage the surface. Dry washed areas thoroughly before use or storing away.

# WARRANTY

Ginny's warrants this product free from defects in material and workmanship for one year from provable date of purchase.

Within this warranty period, Ginny's will repair or replace, at its option, defective parts at no charge, provided the product is returned, freight prepaid with proof of purchase to Ginny's.

Allow 2-4 weeks for return shipping.

This warranty does not cover improper installation, misuse, abuse or neglect on part of the owner.

Warranty is also invalid in any case that the product is taken apart or serviced by an unauthorized service station.

This warranty gives you specific legal rights and they may vary from state to state.

THE FOREGOING WARRANTIES ARE IN LIEU  
OF ALL OTHER WARRANTIES AND CONDITIONS,  
EXPRESS OR IMPLIED,  
INCLUDING BUT NOT LIMITED TO THOSE OF  
MERCHANTABILITY OR FITNESS  
FOR A PARTICULAR PURPOSE.



**Customer Service**

**Phone: 1-800-544-1590**

**8:00 am to Midnight, Monday through Friday**