

Chef
TESTED ✓

by **Montgomery Ward**®

Chef
TESTED ✓

by **Montgomery Ward**®

Greet each morning with the fresh-brewed aroma that starts your day off right!

12-Cup Coffeemaker



Instruction Manual

MODEL: KCD-606
120V~, 60Hz, 1000W

Montgomery Ward Customer Service
3650 Milwaukee Street, Madison, WI 53714
8:00 am to Midnight, Monday through Friday

Wards.com 1-888-557-3848

Wards.com 1-888-557-3848



Chef TESTED ✓

by **Montgomery Ward**®

Thank you for purchasing your Chef Tested 12-cup Coffeemaker by Montgomery Ward. Put through the paces by the experts, we guarantee that it will perform to the highest standard, time after time, with all the convenience, easy clean-up and durability you rely on from Wards.

The coffeemaker has a programmable timer, so you can wake to fresh-brewed java every morning – and you can even sneak a cup with pause-n-serve before it's done!

The coffeemaker will shut off automatically after 2 hours.

The reusable nylon mesh filter may be used with or without paper filters.

Table of Contents

Important Safeguards.....	3-4
Parts & Identification.....	5
Operating Instructions	5-7
Cleaning and Care.....	8
Descaling.....	9
Warranty & Return Information.....	10-11

PLEASE SAVE THESE INSTRUCTIONS

THIS APPLIANCE IS FOR HOUSEHOLD USE ONLY

© 2013 Montgomery Ward, Inc. All rights reserved.

Important Safeguards

When using electrical appliances, basic safety precautions should always be followed including the following:

1. READ ALL INSTRUCTIONS.
2. Do not touch hot surfaces. Use handles or knobs.
3. To protect against electric shock, do not place cord, plug or base unit in water or other liquids.
4. Close supervision is necessary when any appliance is used by or near children.
5. Unplug from outlet when not in use and before cleaning. Allow to cool before putting on or taking off parts, and before cleaning appliance.
6. Do not operate any appliance with a damaged cord or plug or if it has been dropped or damaged in any manner. Call our toll-free customer service number for information regarding replacement, or returning the product.
7. The use of accessory attachments not recommended by manufacturer may cause fire, electric shock or risk of injuries.
8. Do not use outdoors.
9. Do not let cord hang over edge of table or counter, or touch hot surfaces.
10. Do not place on or near a hot gas or electric burner, or in a heated oven.
11. Always fill water reservoir first, then plug cord into the wall outlet. To disconnect, turn controls to "off", then remove plug from wall outlet.
12. Do not use appliance for other than intended use.
13. Snap lid securely onto glass carafe before serving any beverages.
14. Scalding may occur if the lid is removed during the brewing cycle.
15. The glass carafe is designed for use with this appliance only. It must never be used on the range top.
16. Do not set a hot glass carafe on a wet or cold surface.
17. Do not use a cracked glass carafe or a glass carafe having a loose or weakened handle.
18. Do not clean glass carafe or warming plate with steel wool pads, or other abrasive materials.

Important Safeguards (cont'd)

19. **WARNING: TO REDUCE THE RISK OF FIRE OR ELECTRIC SHOCK, DO NOT REMOVE THE BASE PANEL. NO USER SERVICEABLE PARTS ARE INSIDE. REPAIR SHOULD BE DONE ONLY BY AUTHORIZED PERSONNEL.**
20. This appliance is for HOUSEHOLD USE ONLY.

This appliance has a polarized plug (one blade is wider than the other). To reduce the risk of electric shock, this plug will fit in a polarized outlet only one way. If the plug does not fit fully in the outlet, reverse the plug. If it still does not fit, contact a qualified electrician. Do not modify the plug in any way.

SAVE THESE INSTRUCTIONS

Brewing Tips

- Your coffeemaker comes with a reusable mesh filter that can be used without paper filters, saving you money and reducing landfill waste.
- If desired, you can use #4 paper filters (any brand) in the shape that fits your filter basket. Filters may be purchased at most grocery stores.
- Disposable filters should only be used for just one brewing or you may have residue in your coffee or bitter tasting, weak coffee.
- Do not overfill the maximum capacity of 12 level scoops of grounds, to prevent possible overflow.

Parts & Identification

1. Glass carafe
2. Control panel
3. LCD
4. Filter basket
5. Permanent filter
6. Top cover
7. Water tank cover
8. Water level indicator
9. Warming plate
10. Measuring scoop

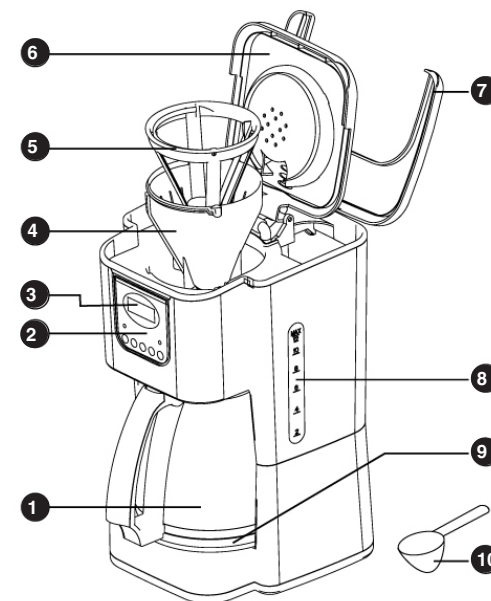

Preparing Coffeemaker for Use

We recommend operating the Coffeemaker once using only water and a paper filter before making the first pot of coffee. This will remove any dust or residue which remains from the manufacturing process.

Operating Instructions

1. Place coffeemaker on a stable, heat-resistant surface.
2. Open the water tank cover, pour the desired amount of cold water in the water tank (watch for level in the water tank). (Figure 1, see p. 6)
3. Lift the permanent filter and fill with desired ground coffee. Use 1 level scoop of ground coffee per cup. (This is a suggested recipe. Adjust the recipe to your taste.) Maximum capacity is 12 level scoops. Do not overfill or the coffeemaker may overflow. After adding ground coffee, place the filter back into position & close the top cover. (Figure 2, see p. 6)
4. Place the carafe on the Warming Plate, plug the unit in.
5. Press "ON/OFF" button to start. (The red LED will illuminate). Press the "ON/OFF" button again, the machine will stop. (The red LED turns off).

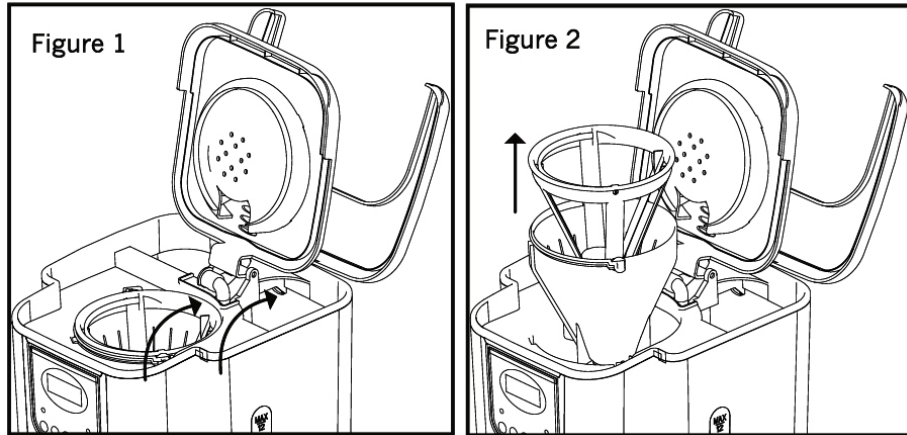

6. Your appliance is equipped with a “pause and serve” feature. This feature allows you to remove the carafe before brewing is complete, stopping the flow of coffee, allowing you to pour a cup and return the carafe for continued brewing. **Warning:** Avoid touching warming plate when carafe is removed.

Programmable Timer

1. Setting the Clock

- When the unit is plugged in, the LCD displays “AM12:00” and flashes. Press “HR” or “MIN” button to stop flashing.
- Press the “PROG” button. The following action should start within 5 seconds.
- Set the hour by pressing “HR” button.
- Set the minutes by pressing “MIN” button.

2. Brewing Coffee At Once

- Press the “ON/OFF” button until the red LED illuminates.
- The coffeemaker will begin operating at once. To deactivate the coffee-maker, press the “ON/OFF” button again, and the coffeemaker will immediately shut off. The red LED will also shut off.

3. Setting the Automatic Timer

- Ensure green LED and red LED are both off, or press the “ON/OFF” button until they are off.
 - Press the “PROG” button twice.
 - Set the expected auto-on time by pressing “HR” button and “MIN” button to set the hours and minutes respectively. The LCD display will switch back to clock mode if there is no button pressing action for 5 seconds. If it happens before the required time can be set, press “PROG” button to redo the step.
 - Press “AUTO” button once to activate timer, green LED will light up, and “Set timer” will appear next to the minutes on the LCD display. The LCD display will return to real time after five seconds.
 - After the coffeemaker finishes an auto-brew cycle, the timer will self-cancel. Therefore, the auto-on time must be programmed every time as needed.
4. Cancel the Auto-on Function/Exit the Program Setting
- If you have programmed a brew cycle time and wish to cancel before the auto brew begins, press the “AUTO” button until the green LED is off.

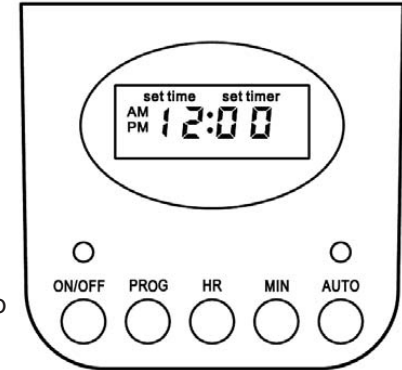

Note:

1. Check the preset auto-on time by pressing “PROG” button twice.
2. At auto-on mode with auto-on time checking, “HR-MIN” buttons cannot be activated.
3. When brewing, the red LED is on.
4. Without pressing any buttons within 5 seconds, LCD will return to real time display automatically.
5. The coffeemaker will shut off automatically after 2 hours.

Cleaning & Care

- Never immerse coffeemaker in water or any other liquid.
- Completely clean and dry all removable parts after every use.
- Always turn coffeemaker OFF and remove the plug from the electrical outlet before cleaning it.
- Open the top cover and remove the permanent or paper filter and the filter basket.
- These can be washed in warm soapy water and rinsed thoroughly, or cleaned in the upper rack of the dishwasher. (Figure 4)
- Do not put any water in the unit once the filter basket has been removed. Wipe the area under the filter basket with a damp cloth.
- Remove the glass carafe from the warming plate. Discard any remaining coffee.
- The carafe and lid can be washed in warm soapy water and rinsed, or in the top rack of your dishwasher.
- Do not use scouring agents or harsh cleansers on any part of the coffeemaker.
- Never immerse base unit in water or other liquid. To clean base, simply wipe with a clean, damp cloth and dry before storing.
- Wipe warming plate with a clean, damp cloth. Never use rough, abrasive materials or cleansers to clean the warming plate.
- Do not dry the inside of the water reservoir with a cloth, as lint may remain.

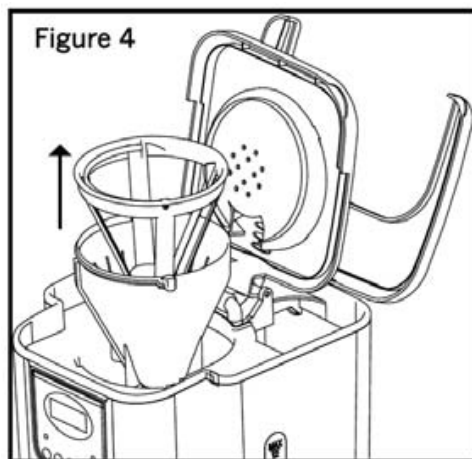

Descaling

To ensure your coffeemaker continues to make good coffee, you should occasionally de-scale the mineral residue left by water using a descaling product specifically formulated for coffeemakers.

The frequency of this operation will depend on the hardness of the water in your area and on how often you use your coffeemaker. If you use it once or twice a day, use the following as a guideline:

- Soft water: de-scale twice a year.
- Medium hard water: descale 4 times a year.
- Very hard water: descale monthly.

Use a standard descaling agent sold for coffeemakers according to application instructions, or use a mixture of $\frac{1}{2}$ vinegar and $\frac{1}{2}$ water. Pour descaling mixture into the reservoir, and switch on appliance.

When descaling liquid has passed completely, empty carafe and pour out hot liquid. Never pour hot descaling solution into water container. Process may need to be repeated due to the hardness of water.

Attention: After descaling it is necessary to operate the appliance 2-3 times with a full container of fresh water as done before the first use. No guarantee is assumed for damages that are due to disregard of the descaling instructions.

Polarized Plug

This appliance has a polarized plug (one blade is wider than the other). As a safety feature to reduce the risk of electrical shock, this plug is intended to fit a polarized outlet only one way. If the plug does not fit fully in the outlet, reverse the plug. If it still does not fit, contact a qualified electrician. Do not attempt to modify the plug in any way.

SHORT CORD INSTRUCTIONS

1. A short power supply cord is provided to reduce the risk resulting from becoming entangled in or tripping over a longer cord.
2. Longer detachable power-supply cords or extension cords are available and may be used if care is exercised in their use.
3. If a long detachable power cord or extension cord is used:
 - The marked electrical rating of the detachable power supply cord or extension cord should be at least as great as the electrical rating of the appliance.
 - If the appliance is of the grounded type, the extension cord should be the same type 3-wire.
 - The longer cord should be arranged so that it will not drape over the counter top or table top where it can be pulled on by children or tripped over.

If any item, for any reason, does not meet your expectations, just return it to us.

We'll gladly either:

- Refund your merchandise amount
- Credit your account
- Send a replacement

You can return any unused item in its original packaging within 60 days of its receipt for a full refund of the purchase price (excluding shipping and handling charges).

Please send returns to:

**Montgomery Ward, Inc.
Attn: Customer Returns
2000 Harrison Suite 100
Clinton, IA 52732-6676**

When returning an item:

- Use the original packaging and pack it securely.
- Please adequately insure your item in case you need to make a claim with the carrier you choose for returning your item.
- Include your order number and reason for return.
- We recommend keeping the receipt for 4 weeks.

Chef

TESTED ✓

1 Year Limited Warranty

Montgomery Ward, Inc. warrants this Chef Tested product to be free from defects in material and workmanship for one year from provable date of purchase.

Within this warranty period, Montgomery Ward will repair or replace, at its option, defective parts of this Chef Tested product at no charge, provided the product is returned, freight prepaid, with proof of purchase, to Montgomery Ward. Allow 2-4 weeks for return shipping.

This warranty does not cover improper installation, misuse, abuse or neglect on part of the owner. Warranty is also invalid in any case that the product is taken apart or serviced by an unauthorized service station.

This warranty gives you specific legal rights and they may vary from state to state.

THE FOREGOING WARRANTIES ARE IN LIEU OF ALL OTHER WARRANTIES AND CONDITIONS, EXPRESS OR IMPLIED, INCLUDING BUT NOT LIMITED TO THOSE OF MERCHANTABILITY OR FITNESS FOR A PARTICULAR PURPOSE.

Montgomery Ward Customer Service
8:00 am to Midnight CST, Monday through Friday

Wards.com 1-888-557-3848