



Salad Assistant Instruction Manual

MODEL: FP-7714



Ginnys.com • 1.800.544.1590

*"Life is happening.
We'll help you live it...one moment at a time."*



Ginny
President, Ginny's

Thank you for purchasing a Ginny's Brand Salad Assistant. Enjoy fast and easy prep time...and maybe even the inspiration to include more variety in your cooking and baking. Making a salad? Line up whatever you like: hard-boiled eggs, carrots, radishes and cucumber, for instance. Give them a quick turn in the salad assistant and you suddenly have a nutritious, delicious and colorful creation! No more slow and tedious cutting and chopping. It's also great for shredding chocolate as a dessert garnish, chopping nuts, and readying potatoes for hash browns or American fries. The sky's the limit. Enjoy!

TABLE OF CONTENTS

Important Safeguards	3
Specifications	4
Part Names	5
Installation	6
How to Operate	7
Cleaning & Care	8
Troubleshooting	9
Warranty	10

IMPORTANT SAFEGUARDS

When using electrical appliances, basic safety precautions should always be followed, including the following:

1. To protect against the risk of electrical shock, do not put this unit, cord or plug in water or other liquids.
2. Never use attachments not meant for this appliance. Only use this appliance for its intended use.
3. Do not let the cord hang over the edge of a table or counter.
4. Do not operate this appliance with a damaged cord or plug, after the appliance malfunctions, or has been damaged in any manner. For a replacement or return, please contact Ginny's Customer Service at our toll-free number.
5. Avoid contact with moving parts. Keep hands, hair, clothing, spatulas and other utensils away during operation to reduce the risk of personal injury and/or damage to the salad assistant.
6. Do not use outdoors.
7. Never leave the salad assistant unattended while in operation.
8. Close supervision is necessary when this appliance is used near children. Children should be supervised to ensure that they do not play with this appliance.
9. Always make sure to thoroughly clean all the parts before using for the first time. See "Cleaning & Care" on page 8.
10. Do not place the salad assistant on hot surfaces such as stoves, hot-plates, or near open gas flames.
11. Switch off the salad assistant and disconnect from a power supply before changing accessories or approaching parts that move.
12. Never feed the food through the food chute with your hands, always use the food pusher.
13. Keep fingers out of the food chute and away from the slicing and grating blades.
14. **Caution:** Slicing and grating blades are extremely sharp. Handle with care.
15. This appliance is not intended for use by persons with reduced physical, sensor or mental capabilities, or lack of experience or knowledge. He or she should not operate this appliance unless he or she is given supervision and instruction concerning use of the appliance by a person responsible for their safety.

SAVE THESE INSTRUCTIONS

No user-serviceable parts inside. A short cord is provided to reduce the hazards resulting of entanglement or tripping over a long cord.

An extension cord may be used with care, however, the marked electrical rating should be at least as great as the electrical rating of this appliance. The extension cord should not be allowed to drape over the counter or tabletop where it can be pulled on by children or tripped over.

FOR HOUSEHOLD USE ONLY

This Salad Assistant is equipped with a polarized plug in which one prong is wider than the other. This is a safety feature, to reduce the risk of electrical shock. The plug will fit into a polarized outlet only one way. If you are unable to insert the plug into the electrical outlet, try reversing the plug. If the plug still does not fit, contact a qualified electrician. Do not attempt to modify the plug in any way.

SPECIFICATIONS

Product Size:	8.5" L x 4.25" W x 11.25" H
Cord Length:	24"
Rate:	AC 120V 60Hz
Wattage:	250W

PART NAMES

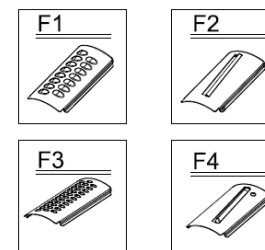
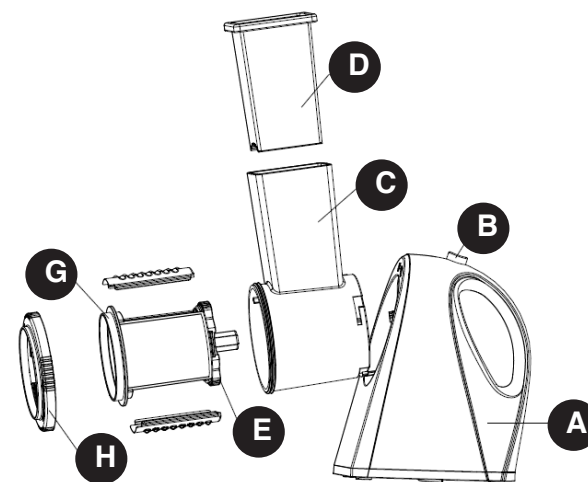

- A. Motor Housing
- B. ON/OFF Switch
- C. Food Chute
- D. Food Pusher
- E. Blade Locking Plate
- F1. Coarse Grating Blade (2 pcs)
- F2. Thin Slicing Blade (2 pcs.)
- F3. Fine Grating Blade (2 pcs.)
- F4. Thick Slicing Blade (2 pcs.)
- G. Blade Holder
- H. Threaded Ring

INSTALLATION

BEFORE USING FOR THE FIRST TIME:

1. Remove all of the packaging.
2. Wash the parts: see "CLEANING & CARE" on page 8.

BEFORE PLUGGING IN:

- **Make sure your electricity supply is the same as the electrical rating specified on the underside of the power unit.**
- **Make sure to fully assemble your salad assistant prior to turning the appliance on or plugging it into a power source.**

1. Place the salad assistant on a dry, level, heat-resistant surface.
2. Select the matching set of blades you would like to use for slicing or grating.
3. Align the outer edges of the blade to the slots on the blade holder. Slide the selected matching blades into the blade holder until the end of the blade slides into the curved slot. (Fig. 1)
4. Make sure to slide the blade locking plate over the shaft on the blade holder and turn counter-clockwise to lock the blades into place.
5. Place the assembled blades and blade holder into the food chute. (Fig. 2)
6. Place the threaded ring over the end of the food chute. Turn the threaded ring counter-clockwise to lock onto the chute. (Fig. 3)
7. Attach the assembled food chute/blade holder/threaded ring to the motor housing by lining up the shaft on the food pusher to the drive gear on the motor housing. (Fig. 4)
8. Turn the assembled components counter-clockwise to lock into the motor housing. (Fig. 5)
9. To disassemble your salad assistant, complete steps 3-8 in reversed sequence.

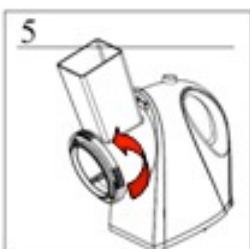
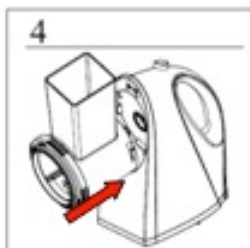
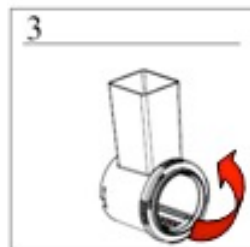
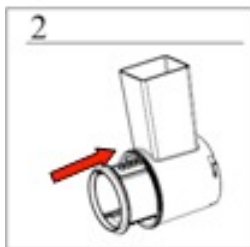
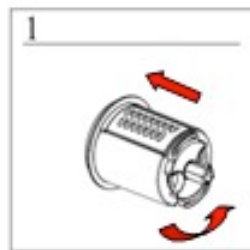

HOW TO OPERATE

1. Plug the salad assistant into an outlet.
2. Place food into the food chute and rest the food pusher over the food.
3. Turn on the salad assistant and press down on the food pusher with even pressure.
4. The salad assistant will begin to discharge sliced or grated food from the blade holding chamber.
5. When finished slicing or grating food, turn the salad assistant off and unplug from the power source.

IMPORTANT: Do not use any meat in this salad assistant due to the risk of cross-contamination.

NOTE: Your Salad Assistant can be used while resting on a level surface

BLADE GUIDE

	Coarse Grating Blade (F1)	Thin Slicing Blade (F2)	Fine Grating Blade (F3)	Thick Slicing Blade (F4)
Carrots	●	●	●	●
Zucchini	●	●	●	●
Cucumber	●	●	●	●
Potatoes	●	●	●	●
Radishes	●	●	●	●
Nuts	●	●	●	●
Cheese	●	●	●	●
Hard-Boiled Eggs	●	●	●	●
Peppers	●	●		●
Onions		●		●
Beets		●		●
Cabbage		●		●
Apples		●		●
Chocolate	●		●	
Coconut			●	

CLEANING & CARE

Always switch off, unplug and disassemble this salad assistant before cleaning.

- Never immerse the salad assistant in water, or let the cord or plug get wet.
- Allow the salad assistant to cool down prior to cleaning.
- Do not use scouring powders, steel wool pads or other abrasive materials to clean this salad assistant.

MOTOR HOUSING

- Detach the food chute from the motor housing before cleaning.
- Wipe down the motor housing with a warm, damp cloth.
- Dry thoroughly.
- Do not immerse in water.

ALL OTHER ATTACHABLE COMPONENTS

- Disassemble all attached parts before cleaning.
See "INSTALLATION" on page 6.
- Wash in warm, sudsy water.
- Rinse and dry thoroughly.
- All attachable components for this salad assistant are top rack only, dishwasher safe.

Note: If the plastic housing or parts become stained after processing certain foods, simply use a small amount of cooking oil with a paper towel to wipe down the stained area. For best results, do this immediately after noticing the stain.

STORAGE

- Before storing away, make sure the salad assistant is completely disassembled and cleaned.
- Store in a cool, dry location.

TROUBLESHOOTING

Before asking for service, please check for the following:

1. Check that the salad assistant is plugged in securely. If it is not, remove the plug from the outlet, wait 10 seconds, and plug it in again securely.
2. Check for a blown circuit fuse or a tripped circuit breaker.
If these seem to be operating properly, test the outlet with another appliance.

If none of the above rectify the situation, contact
Customer Service
1.800.544.1590

Do not try to adjust or repair the appliance yourself.

WARRANTY

Ginny's warrants this product free from defects in material and workmanship for one year from provable date of purchase.

Within this warranty period, Ginny's will repair or replace, at its option, defective parts at no charge, provided the product is returned, freight prepaid with proof of purchase to Ginny's.

Allow 2-4 weeks for return shipping.

This warranty does not cover improper installation, misuse, abuse or neglect on part of the owner.

Warranty is also invalid in any case that the product is taken apart or serviced by an unauthorized service station.

This warranty gives you specific legal rights and they may vary from state to state.

THE FOREGOING WARRANTIES ARE IN LIEU
OF ALL OTHER WARRANTIES AND CONDITIONS,
EXPRESS OR IMPLIED,
INCLUDING BUT NOT LIMITED TO THOSE OF
MERCHANTABILITY OR FITNESS
FOR A PARTICULAR PURPOSE.



Customer Service

Phone: 1-800-544-1590

8:00 am to Midnight, Monday through Friday