



Model: MW-50-1102PS

Montgomery Ward Customer Service
1112 7th Avenue, Monroe, WI 53566
8:00 a.m. to Midnight CT, Monday through Friday

Wards.com 1-888-557-3848

Instruction Manual

Item No.: 750843
120V~, 60Hz, 3Amp, 128W

Wards.com 1-888-557-3848



Thank you for purchasing your 1.6 cu. ft. Portable Washing Machine by Montgomery Ward®. It will perform to the highest standard, time after time, with all the convenience and durability you rely on from Wards. We guarantee it!

Your Portable Washing Machine is built small enough to fit in tight spaces, but durable enough to handle all of your laundry needs. Your appliance can be installed in just a few easy steps. When you don't need it, just roll it away for easy storage!

Table of Contents

Important Safeguards	3-4
3-Prong Plug.....	4
Parts & Features.....	5
Installation	6-7
How to Use	8-10
Cleaning & Care	11
Helpful Hints	11
Troubleshooting	12-13
Warranty & Return Information.....	14-15

PLEASE SAVE THESE INSTRUCTIONS

THIS APPLIANCE IS FOR HOUSEHOLD USE ONLY

© 2017 Montgomery Ward, Inc. All rights reserved.

Important Safeguards

PLEASE READ THESE INSTRUCTIONS BEFORE USE

Basic safety precautions should always be followed when using this appliance.

WARNING: TO AVOID THE RISK OF ELECTRICAL SHOCK, ALWAYS MAKE SURE THE PRODUCT IS UNPLUGGED FROM THE ELECTRICAL OUTLET BEFORE ASSEMBLING, DISASSEMBLING, RELOCATING OR CLEANING.

DANGER: Risk of child entrapment

- Child entrapment and suffocation are not problems of the past. Junked or abandoned appliances are still dangerous (even if they will “just sit in the garage for a few days”).
 - Before you throw away your old washing machine, remove the lid so that children do not become trapped inside.
1. Close supervision is necessary when any appliance is used by or near children. Do NOT allow children to play on or in this appliance.
 2. NEVER leave appliance unattended while in use.
 3. To protect against electrical shock, do NOT place cord, plug or appliance in water or other liquid.
 4. Do NOT let cord hang over edge of table or counter or touch any hot surfaces.
 5. Do NOT allow appliance to rest on cord.
 6. To disconnect from electrical outlet, pull directly on plug; do NOT pull on the cord.
 7. NEVER connect or disconnect plug with wet hands.
 8. Do NOT operate any appliance with a damaged cord or plug, or after the appliance malfunctions or has been damaged in any manner. Call our toll-free customer service number for information regarding returning or replacing the product.
 9. Turn power OFF before removing plug from outlet.
 10. Turn off faucet and unplug if the machine will not be used for a long period of time.
 11. Do NOT allow water to get on control panel.
 12. Do NOT install your washer in areas where water may freeze, since your washer will always retain some water in its water valve, pump and hose areas. Frozen water can damage the belts, pump, hoses and other components.
 13. Install washer on a hard, level surface that can support its weight. Do NOT install on carpeting.
 14. Do NOT sit or stand on washer.
 15. Do NOT expose appliance to direct sunlight.
 16. Keep appliance away from heat and exposed flames.
 17. Keep hands clear from moving parts when machine is in use.
 18. Lid must be closed prior to use. Do NOT open lid when machine is in use.
 19. Do NOT operate the washer if detergent dispenser has been removed.
 20. Do NOT leave faucet on when machine is not in use.
 21. Do NOT use abrasive cleansers or pads to clean interior or exterior of machine.

Important Safeguards (cont'd)

22. Do NOT reach into the washer while parts are moving. Allow the tub to come to complete stop before reaching inside.
23. Shake loose dirt and sand out of laundry prior to washing.
24. Follow the care instructions supplied by garment manufacturer.
25. Always check inside of washer for foreign objects before loading laundry.
26. Do NOT add gasoline, dry cleaning solvents or other flammable substances to wash water. These substances give off vapors that could ignite or damage the washing machine.
27. Do NOT store or use gasoline or other flammable fluids near this appliance. The fumes can create a fire hazard or explosion.
28. Do NOT wash articles that have been soaked or spotted with gasoline, dry cleaning solvents or other flammable or explosive substances as they give off vapors that could ignite or explode.
29. Only use liquid and powder detergents approved for use in a high efficiency (HE) washing machine.
30. Discard appliance following local ordinances. Remove lid to prevent child entrapment.
31. Do NOT use appliance for other than its intended use.

3-Prong Plug

This appliance has a 3-prong (grounding) plug for use in a 3-prong (grounding) outlet to minimize the possibility of electric shock. This appliance should only be used with a 120V, 60Hz grounded outlet. Failure to follow these instructions could result in fire, electrical shock, serious injury or death.

If the plug does not fit fully in the outlet, contact a qualified electrician to install a 3-prong (grounding) outlet. Do NOT attempt to modify the plug in any way. Do not use an adapter or an extension cord that is not rated for use with this product. Failure to follow these instructions could result in fire, electrical shock, serious injury or death.

Parts & Features

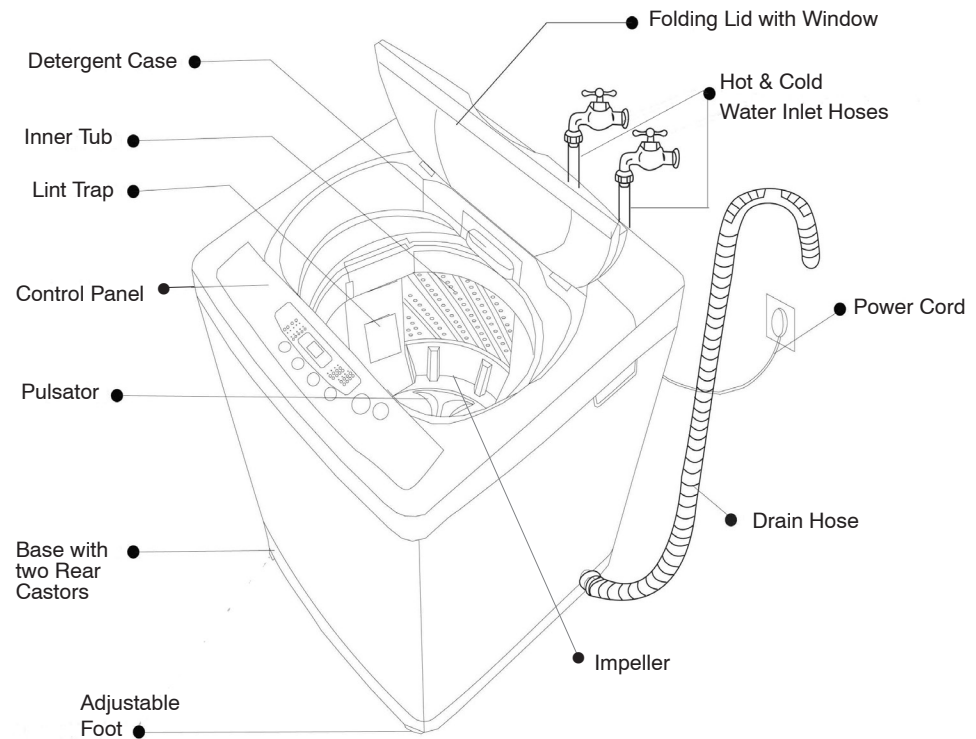

Accessories

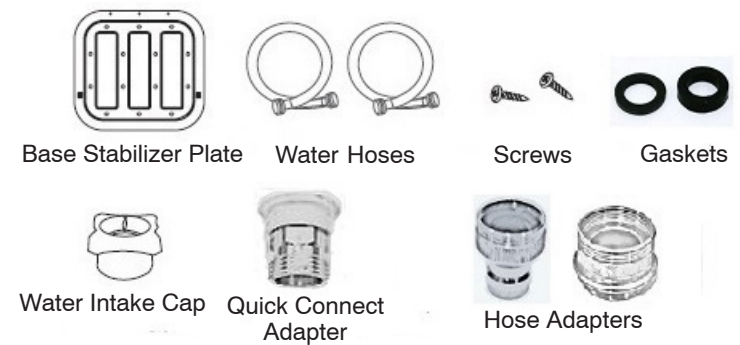

WARNING: Risk of suffocation - keep all packaging and plastic bags out of the reach of children.

- Dispose of packaging materials in accordance with local ordinances.
- Install and store appliance where it will not be exposed to direct sunlight or temperatures below freezing.

1. Move washer to desired location by grasping the handles on the sides, tilting the appliance back on its rear wheels and pushing forward.
2. While washer is tilted, remove any packaging materials on the bottom of the unit.
3. Slide the base stabilizer plate on to the bottom of the machine and screw into place.
4. Install washer on a stable, level, non-carpeted surface. The machine must be level to operate safely and for peak efficiency. Use the adjustable foot, located on the front right, to level the machine.



Inlet Hose Connection - Single Faucet

If you are connecting the washer to a sink with separate hot and cold faucets, move to the next section.

Your portable washing machine comes with a quick connect adapter for quick connection to a single faucet, typically the kitchen sink.

The adapter consists of two parts: the faucet fitting for connection to the faucet and the hose fitting, which connects to the cold water hose of the washer.

1. Pull back on the white ring of the quick connect adapter to free the faucet fitting from the adapter.
 - If the faucet has internal screw threads, unscrew the aerator, if present, from the faucet. Then screw the faucet fitting into the faucet. Make sure that the black rubber gasket is on the top of the adapter before screwing it in.
 - If the faucet has external screw threads, remove the gasket from the top of the faucet fitting and screw the fitting over the external threads.
2. Screw the end of the cold water hose onto the base of the hose fitting.
3. Pull back on the white ring to connect the two parts of the adapter back together.

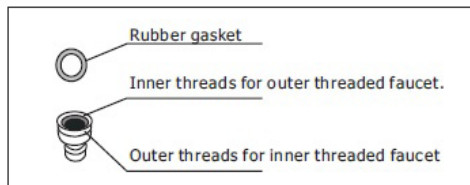
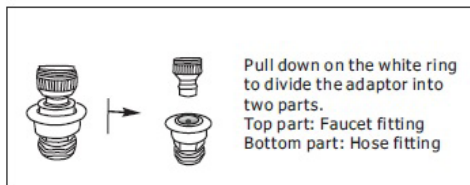

4. Insert the water intake cap into the hot water inlet on the back of the machine.

Inlet Hose Connection - Dual Faucet

The quick connect adapter is primarily for quick connection to a single faucet, however it can be used on the cold water faucet when there are two faucets. See instructions in the previous section for installing the adapter.

1. Connect the ends of the water supply hoses to the hose adapters and then connect the adapters to the HOT and COLD faucets. You may need to remove the aerators from the faucets, depending on the type of faucet.
2. Tighten the fittings by hand until snug, then tighten them an additional two-thirds of a turn with a wrench.

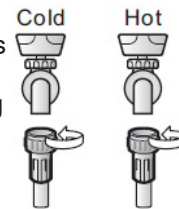

IMPORTANT: Do NOT apply tape or sealant to the faucets or water supply intakes, as this can damage the fittings.

3. Pull down on the water supply hoses to confirm they are securely connected to the faucets.
4. Place the unconnected ends of the hoses into a bucket and open the faucets for 10–15 seconds to remove any foreign substances from the hoses. Turn off the faucets before continuing.
5. Connect the ends of the water supply hoses to the intake connections at the back of the washer.



IMPORTANT: Make certain that the cold water hose is connected to the cold water intake and the hot water hose to the hot water intake.

6. Tighten the fittings by hand until snug, then tighten them an additional two-thirds of a turn with a wrench.

IMPORTANT: Confirm that the water supply hoses are not twisted or bent. A twisted or bent hose can leak and cause electric shock due to the water leakage.

7. Turn on both faucets and check all of the connections for leaks. If leaks occur, tighten the connections.

Connect the Drain Hose

Unhook the drain hose from the side of the washer and drain in one of these ways:

- On the side of a sink with a hook or to the faucet with string, to prevent the drain hose from moving.
- In a standpipe that is no shorter than 32" and no taller than 39".
- In a laundry tub that is no shorter than 32" and no higher than 39".

IMPORTANT: Make sure that the connection between the drain hose and the sink, standpipe or laundry tub is NOT airtight.

Post-Installation

1. Place a level on the washing machine to confirm that it is in a level position. If needed, adjust the level using the adjustable foot on the front, right side.
2. Plug the washing machine into a 120V, 60Hz grounded outlet.

Control Panel

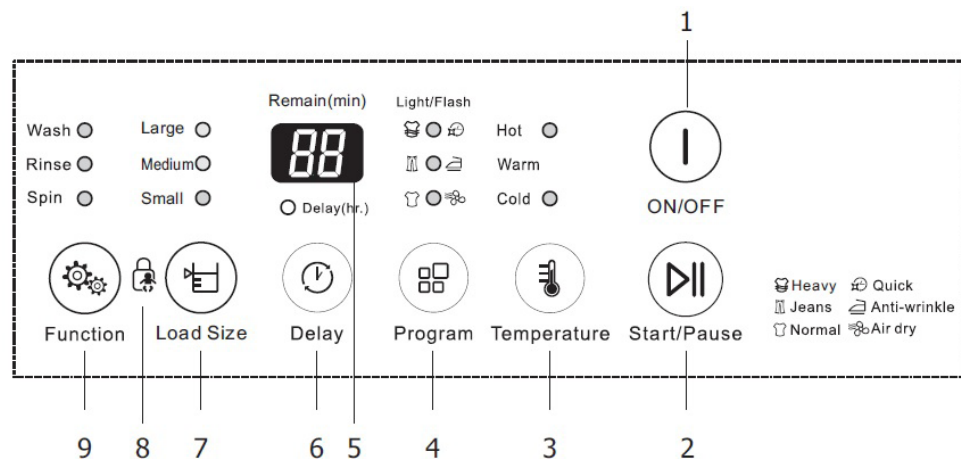

1.	Power Button - Turns the machine on and off.
2.	Start/Pause Button - Use to start or pause the cycle.
3.	Temperature Button - Use to select water temperature.
4.	Program Button - Use to select desired washing program, as indicated by the steady or flashing light next to the program.
5.	Digital Display - Shows time remaining when a cycle is in process, time remaining until washing will begin when the delay function is active and when the child lock is engaged.
6.	Delay Button - Use to select desired amount of time to delay the start of the washing cycle.
7.	Load Size Button - Use to select water level, as indicated by the light next to Large, Medium or Small.
8.	Child Lock Icon - A visual reminder of how to set the lock.
9.	Function Button - Use to select one or all cycles (Wash, Rinse, Spin).

- Press the **power** button to turn machine ON.
 - Distribute laundry evenly around the tub. Do NOT fill tub more than $\frac{3}{4}$ full. For best results, articles should move freely through wash water. Maximum laundry load weight is 11 lbs.
 - Add detergent to detergent case, using only detergent made for high efficiency (HE) washers.
- NOTE: The suggested amount of detergent to use is $\frac{1}{4}$ to $\frac{1}{2}$ of the maximum amount recommended by the detergent manufacturer, depending on load size.
- Press the **program** button to select the setting that best fits your washing needs.
- NOTE: Program selection is indicated by a steady or flashing light. See table below.

Steady Light		Flashing Light	
	Heavy		Quick
	Jeans		Anti-Wrinkle
	Normal		Air Dry

NOTE: The air dry setting helps remove excess water from laundry during the spin cycle.

- Press the **load size** button and choose the best option based on amount of laundry being washed.
 - Use the **function** button to select the cycles to be used. An illuminated light next to the cycle name will indicate that cycle will be used. To use a full cycle of wash, rinse and spin, make sure that lights next to all three options are illuminated.
 - Press the **temperature** button to select the water temperature for washing. When both cold and hot lights are illuminated, warm water will be used.
- NOTE: Only cold should be chosen when a single cold hose system is used.
NOTE: Cold water only is used for the rinse cycle.
- Close the lid and press the **start/pause** button to begin the cycle.
- The number of minutes for the cycle to complete will appear on the digital display. If the Delay Start feature was used, the display will countdown the time until the cycle begins.

NOTE: Clean lint trap after every use. Turn off faucet when washer is not in use.

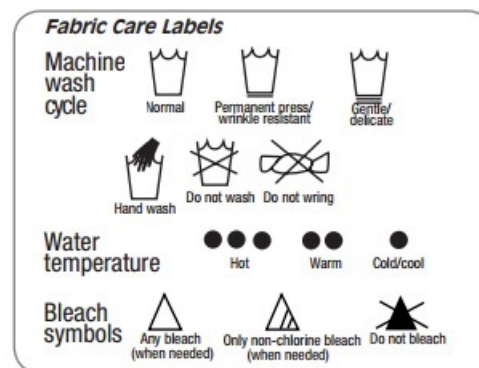

Pause Cycle

To add a forgotten item to the washer once the cycle has begun:

1. Press the **start/pause** button.
2. Wait for the tub to stop spinning.
3. Open lid and add item.
4. Close lid and press the **start/pause** button to resume the cycle.

Delay Start Feature

Select this option when you want to load the washer but wait until a later time to run the wash cycle.

1. Follow steps 1–7 on preceding page. Do NOT press the start/pause button.
2. Press the **delay** button. For each press of the button the time on the display will increment by 1 hour, up to 24 hours.
3. Pressing the delay button after 24 hours has been reached will increment the time by 6 hours, up to 48 hours.
4. When the display shows 48 hours, pressing the delay button will cancel the function and the light next to delay will go out.

Child Lock

Use the child lock to prevent changing the operation status of the unit.

The lock can be set after washing has begun or when the machine is not in use, to prevent accidental start.

To engage the lock, simultaneously press and hold the **function** and **load size** buttons. The digital display will show CL alternately with the remaining time or delay time.

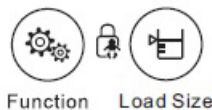

To disengage the lock, simultaneously press and hold the **function** and **load size** buttons. The CL will disappear from the digital display.

When the child lock is activated, no buttons will function except for the power button and the ability to deactivate the child lock, as described above.

Cycle Guide

Program	Load Size (default Lrg)	Soak & Wash Time (min.)	Number of Rinse Cycles	Spin Time (min.)	Total Time (min.)
Heavy	Sm, Med, Lrg	12	2	5	42
Quick	Sm, Med, Lrg	3	1	½	10
Jeans	Sm, Med, Lrg	17	2	1	42
Anti-Wrinkle	Sm, Med, Lrg	12	2	–	34
Normal	Sm	15½	1	6	36
	Med	15½	1	10	44
	Lrg	15½	1	18	50
Air Dry	–	–	–	57	60

This appliance contains no user-serviceable parts. Do NOT try to repair it yourself. If your appliance is damaged or does not operate, call our toll-free customer service number for information regarding returning or replacing the product.

Precautions:

- Always unplug machine before cleaning.

To Clean:

- Turn off faucets.
- Open the lid to allow the inside to dry out.
- Wipe exterior surface of the machine, including the control panel with a soft, slightly damp cloth or sponge. Do NOT use abrasive cleaners or sponges.
- Clean lint trap after every use:
 - » Remove lint trap by pulling straight up and out.
 - » Manually remove lint.
 - » Wash and rinse trap thoroughly using straight tap water.
 - » Reinstall lint trap.
- Once a month, run the quick program cycle using 1 cup of bleach. This will clean the tub and help prevent build-up of mold.
- Remove the pump filter, located on the rear of the washer. Wash it thoroughly in water and replace in machine.

To Store:

- Be sure all parts are clean and dry before storing.
- Store appliance in a clean, dry place. NEVER store it while it is hot or wet.

Helpful Hints

Before Loading the Washer:

- Check all pockets to make sure they are empty. Coins, paper clips, pens, keys and other small items can cause damage to laundry and/or machine.
- Close zippers, hooks and drawstrings to prevent snagging and tangling with other clothes.
- Pre-treat heavily stained areas for best results.

Troubleshooting

Before calling for service, try these troubleshooting tips.

Problem	Possible Cause	Remedy
Washer does not operate. NOTE: If the washer stopped during a cycle due to a loss of power, the washer will resume the cycle when the power is restored.	Not plugged in. The circuit breaker tripped or fuse is blown. The lid is not closed. Water source is not on. Machine has been paused. Delay start program is in use. Washer is cold.	Confirm plug is secure in outlet. Reset circuit breaker or replace fuse. Close lid. Turn on water faucet(s). Press start/pause button. Check digital display for remaining time until start of cycle. If the washer has been exposed to temperatures below freezing for an extended period of time, allow it to warm up before pressing the power button.
No water or insufficient water supply.	Water source is not turned on. Water hose is bent or frozen.	Turn on water faucet(s). Turn off water faucets, check hose(s) for bends or kinks. Remove hose(s) to thaw out, reinstall hose(s) and move machine to a location where hoses cannot freeze.
Washing machine does not drain.	Drain hose is kinked. Drain is located more than 39" above the floor.	Straighten out drain hose to remove kink. Make sure that the drain hose is no higher than 39" above the bottom of the washer and is no more than 5 ft. away from the washer.
Washing machine vibrates, thumps or is too noisy.	Washer is not level. Washer is touching another object. Laundry load is not balanced. The base stabilizer plate has not been installed. Foreign objects, such as keys, coins, etc. are in the tub.	Use adjustable foot to level washer. Make sure washer is not coming in contact with counters or other objects. Pause cycle, open lid and redistribute laundry. Install base stabilizer plate. Stop washer, check tub and drain filter for foreign objects.

Troubleshooting

Problem	Possible Cause	Remedy
Tub does not spin.	Lid is not closed. Washer is not on a level surface. The laundry load is not balanced.	Close lid. Level washer. Pause cycle, open lid and redistribute laundry.
Water leaks.	Hoses are loose or not installed correctly. A large item, such as a pillow or blanket is above the top of the tub. Over sudsing of detergent.	Check water and drain hose connections to ensure that they are tight and secure. Pause the washer to make sure the load does not crest above the top edge of the tub. Only use detergent made for high efficiency (HE) washers in $\frac{1}{4}$ to $\frac{1}{2}$ of the maximum amount recommended by the detergent manufacturer.
Excessive sudsing.	Too much or incorrect detergent.	Only use detergent made for high efficiency (HE) washers in $\frac{1}{4}$ to $\frac{1}{2}$ of the maximum amount recommended by the detergent manufacturer.
Clothes come out wrinkled.	Laundry not removed promptly. Washer overloaded. Hot and cold water hoses are reversed.	Remove laundry as soon as cycle ends. Do NOT fill tub more than $\frac{3}{4}$ full. Hot water rinse can set wrinkles in garments. Check the inlet hose connections.
Error Code E1	It takes over 30 minutes to fill water and it cannot achieve the preset water level.	Read remedies for No water or insufficient water supply and Water leaks .
Error Code E2	The lid is open.	Close the lid.
Error Code E3	The laundry load is out of balance.	Redistribute laundry.
Error Code E4	It takes over 10 minutes for the washer to drain and it does not drain the tub completely.	Read remedy for Washing machine does not drain .
Error Code E5	Water overfills machine.	Call our toll-free customer service number.

If any item, for any reason, does not meet your expectations, just return it to us. We'll gladly either:

- Refund your merchandise amount
- Credit your account
- Send a replacement

You may return any unused item in its original packaging within 60 days of its receipt for a full refund of the purchase price (excluding shipping and processing charges).

Please send returns to:

**Montgomery Ward, Inc.
Attn: Customer Returns
2000 Harrison Suite 100
Clinton, IA 52732-6676**

When returning an item:

- Use the original packaging and pack it securely.
- Please adequately insure your item in case you need to make a claim with the carrier you choose for returning your item.
- Include your order number and reason for return.
- We recommend keeping the receipt for 4 weeks.



1 Year Limited Warranty

Montgomery Ward, Inc. warrants this product to be free from defects in material and workmanship for one year from provable date of purchase.

Within this warranty period, Montgomery Ward will repair or replace, at its option, defective parts of this product at no charge, provided the product is returned, freight prepaid with proof of purchase to Montgomery Ward. Allow 2–4 weeks for return shipping.

This warranty does not cover improper installation, misuse, abuse or neglect on part of the owner. Warranty is also invalid in any case that the product is taken apart or serviced by an unauthorized service station.

This warranty gives you specific legal rights and they may vary from state to state.

THE FOREGOING WARRANTIES ARE IN LIEU OF ALL OTHER WARRANTIES AND CONDITIONS, EXPRESS OR IMPLIED, INCLUDING BUT NOT LIMITED TO THOSE OF MERCHANTABILITY OR FITNESS FOR A PARTICULAR PURPOSE.

Montgomery Ward Customer Service
8:00 a.m. to Midnight CT, Monday through Friday

Wards.com 1-888-557-3848